

GN 471.3 | Aluminum Crank Handles

Inch and Metric Size • With Locking Retractable Handle

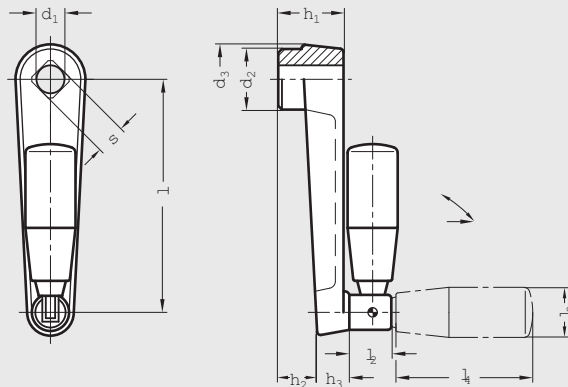

ISO 9001 Supplier

RoHS Compliant

Crank body

Aluminum, black powder coated pebble finish

Contact face of hub machined

Crank handles with retractable hand piece are mainly used for applications where the hand piece must not protrude.

Special inch and metric bores, squares, keyways, set screw holes, etc. available upon request.

Retractable handle

Black phenolic plastic hand piece, black oxide steel stem and mechanism, see GN 598.3 series for further details, page 178.

In the operating position, the hand piece is firmly locked. By pulling the hand piece in the axial direction out of its locating cone, it can be folded back into place. The spring holds the hand piece firmly in both positions.

Inch Table

Dimensions in: inches (millimeters)

Part Number	l	d ₁ Through Bore	s Through Square	d ₂	d ₃	h ₁	h ₂	h ₃	l ₂	l ₃ Ø	l ₄
4BC01	3.94	.500		1.06	1.18	1.10	.67	.51	.77	.91	2.56
4VC01	(100)		.500	(27)	(30)	(28)	(17)	(13)	(19.5)	(23)	(65)
5BC02	4.92	.625		1.26	1.38	1.34	.87	.55	.77	.91	2.56
5VC02	(125)		.625	(32)	(35)	(34)	(22)	(14)	(19.5)	(23)	(65)
4BC03	6.30	.500		1.38	1.54	1.50	1.02	.55	.77	1.02	3.15
6BC03	(160)	.750		(35)	(39)	(38)	(26)	(14)	(19.5)	(26)	(80)
6VC03			.750								

Metric Table

Dimensions in: millimeters (inches)

Part Number	l	d ₁ Through Bore	s Through Square	d ₂	d ₃	h ₁	h ₂	h ₃	l ₂	l ₃ Ø	l ₄
12MC01	100	12		27	30	28	17	13	19.5	23	65
12QC01	(3.94)		12	(1.06)	(1.18)	(1.10)	(.67)	(.51)	(.77)	(.91)	(2.56)
14MC02	125	14		32	35	34	22	14	19.5	23	65
14QC02	(4.92)		14	(1.26)	(1.38)	(1.34)	(.87)	(.55)	(.77)	(.91)	(2.56)
17MC03	160	17		35	39	38	26	14	19.5	26	80
17QC03	(6.30)		17	(1.38)	(1.54)	(1.50)	(1.02)	(.55)	(.77)	(1.02)	(3.15)