

GN 346 | Steel Ball Joint Thrust Pads

Metric Size

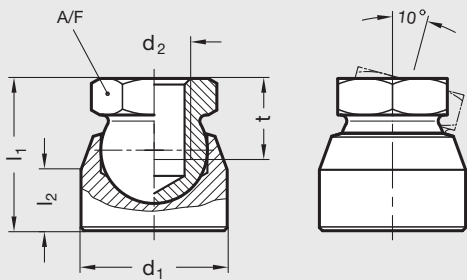

NEW



ISO 9001 Supplier

RoHS Compliant

**Thrust pads**  
Steel, zinc plated, blue passivated, tensile strength 500 N/mm<sup>2</sup>

GN 346 ball joint thrust pads are generally used for the transfer of clamping forces. They accommodate uneven or non-parallel surfaces and clamp without twisting the clamped parts.

The static loads indicated in the table were determined by a series of tests, wherein a limited number of thrust pads were subjected for a limited time to vertical static loads. At the values shown, a permanent deformation of the ball is almost impossible.

These thrust pads can also be used as leveling feet with a small foot diameter.

11

Metric Table

Dimensions in: millimeters (inches)

Part Number	d <sub>1</sub>	d <sub>2</sub> Thread	l <sub>1</sub>	l <sub>2</sub>	t min.	A/F	Static Load [N]
8NDB6	16 (.63)	M8 x 1.25	19 (.75)	7 (.28)	9 (.35)	12 (.47)	500
10NDB7	20 (.79)	M10 x 1.5	22 (.87)	8 (.31)	11 (.43)	15 (.59)	7500
12NDB8	24 (.94)	M12 x 1.75	25 (.98)	10 (.39)	12 (.47)	17 (.67)	10000
16NDB9	30 (1.18)	M16 x 2.0	31 (1.22)	13 (.51)	16 (.63)	24 (.94)	15000

Jig, Fixture and Fastening Components