

GN 369 | Steel Commercial Crank Handles

Metric Size • With Revolving Handle

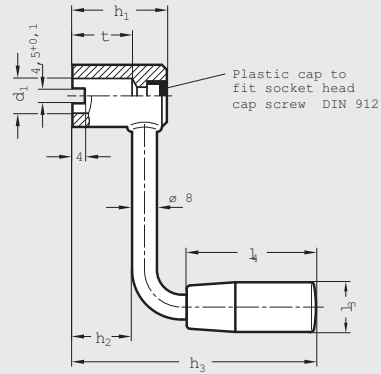
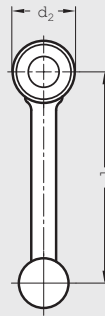

ISO 9001 Supplier

RoHS Compliant

Crank body

Steel, sandblasted and nickel plated

Crank arm and hub

Butt-welded

Cap

Black nylon plastic

Revolving hand piece

Black phenolic plastic

Both dimensions, inch and metric, are interchangeable

Commercial crank handles GN 369 are for light duty application and are of extremely good value. A suitable dowel in the shaft and the slot in the handle hub provides an economical connection to the shaft. To secure the handle permanently to the shaft, remove the plastic cap and insert screw.

Also, a simple drill and pin connection is possible with crank handle without slot.

Due to the production method which is not dependent on a specific shape, these crank handles can be produced as specials at a competitive price.

Special inch and metric bores larger than listed also available upon request.

Other modifications such as cross holes and set screw holes also available.

Metric Table

Dimensions in: millimeters (*inches*)

Part Number		l	d ₁ Blind Bore	d ₂	h ₁	h ₂₌	h ₃₌	t (+.5 mm)	l ₃ Ø	l ₄	DIN 912 Screw Size
Without Slot	With Slot										
10MC22/A	10MC22/N	63 (2.48)	10 (.394)	18 (.71)	28 (1.10)	18 (.71)	74 (2.91)	18 (.71)	18 (.71)	40 (1.57)	M5
10MC23/A	10MC23/N	80 (3.15)	10 (.394)	18 (.71)	28 (1.10)	18 (.71)	74 (2.91)	18 (.71)	18 (.71)	40 (1.57)	M5
12MC24/A	12MC24/N	100 (3.94)	12 (.472)	20 (.79)	30 (1.18)	20 (.79)	88 (3.46)	20 (.79)	21 (.83)	50 (1.97)	M6
12MC25/A	12MC25/N	125 (4.92)	12 (.472)	20 (.79)	30 (1.18)	20 (.79)	88 (3.46)	20 (.79)	21 (.83)	50 (1.97)	M6