

GN 300 | Zinc Die-Cast Adjustable Levers

With Steel Components • Tapped or Blind Bore Type • Inch and Metric Size

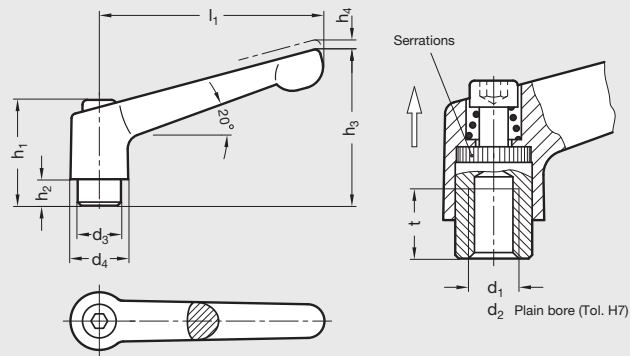

1

Adjustable Levers

ISO 9001 Supplier

RoHS Compliant

Handle

Zinc die-cast

Insert, screw and spring

Steel, black oxide finish

Standard colors

- K** Matte Black Pebbled Finish, electrostatically applied powder coat
- O** Orange
- R** Red
- G** Gray
- C** Chrome Plated
- V** Silver
- Z** Uncoated

Adjustable hand levers GN 300 are the result of modern industrial design.

All such levers have proven to be ideal wherever parts have to be clamped in a confined space or in a particular lever position. The insert is connected to the lever via serrations which can easily be disengaged.

Pulling the lever upwards, disengages the serrations, allowing it to be swivelled to the ideal clamping position. When releasing the lever, the serrations automatically re-engage.

Special colors, bores, and threads are available upon request.

Inch Table

Dimensions in: inches (millimeters)

Part Number Black	l_1	d_1 Tapped	d_2 Blind Bore	d_3	d_4	h_1	h_2	h_3	h_4	t min	A/F
1TA19K	1.18 (30)	10-32		.39 (10)	.49 (12.5)	.96 (24.5)	.16 (4)	1.04 (26.5)	.14 (3.5)	.31 (8)	.12 (3.1)
2TA19K		10-24									
3TA19K		1/4-20									
1BA19K			.250								
1TA01K	1.77 (45)	10-32		.39 (10)	.51 (13)	.96 (24.5)	.16 (4)	1.38 (35)	.14 (3.5)	.31 (8)	.12 (3.1)
2TA01K		10-24									
3TA01K		1/4-20									
1BA01K			.250								
3TA02K	2.48 (63)	1/4-20		.53 (13.5)	.69 (17.5)	1.22 (31)	.26 (6.5)	1.77 (45)	.16 (4)	.39 (10)	.16 (4.1)
5TA02K		5/16-18									
1BA02K			.250								
2BA02K			.313								
5TA03K	3.07 (78)	5/16-18		.63 (16)	.83 (21)	1.42 (36)	.31 (8)	2.17 (55)	.16 (4)	.55 (14)	.16 (4.1)
6TA03K		3/8-16									
2BA03K			.313								
3BA03K			.375								
6TA04K	3.62 (92)	3/8-16		.75 (19)	.94 (24)	1.69 (43)	.43 (11)	2.56 (65)	.16 (4)	.67 (17)	.20 (5.1)
8TA04K		1/2-13									
3BA04K			.375								
4BA04K			.500								

Table continued...

* For optional-standard colors replace the last digit with the desired suffix: **K** (Matte Black Pebbled Finish), **O** (Orange), **R** (Red), **G** (Gray), **C** (Chrome Plated), **V** (Silver), **Z** (Uncoated). Example of part number for Orange lever: 1TA01O



Dimensions in: inches (millimeters)

Part Number Black	l ₁	d ₁ Tapped	d ₂ Blind Bore	d ₃	d ₄	h ₁	h ₂	h ₃	h ₄	t min	A/F
8TA05K	4.25 (108)	1/2-13		.91 (23)	1.18 (30)	1.99 (50.5)	.47 (12)	2.99 (76)	.20 (5)	.91 (23)	.20 (5.1)
10TA05K		5/8-11									
4BA05K			.500								
5BA05K			.625								

Metric Table

Dimensions in: millimeters (inches)

Part Number Black	l ₁	d ₁ Tapped	d ₂ Blind Bore	d ₃	d ₄	h ₁	h ₂	h ₃	h ₄	t min	A/F
3NA19K	30 (1.18)	M3 x .5		10 (.39)	12.5 (.49)	17.7 (.96)	4 (.16)	26.5 (1.04)	3.5 (.14)	8 (.31)	3.1 (.12)
4NA19K		M4 x .7									
5NA19K		M5 x .8									
6NA19K		M6 x 1.0									
5MA19K			5								
6MA19K			6								
4NA01K	45 (1.77)	M4 x .7		10 (.39)	13 (.51)	24.5 (.96)	4 (.16)	35 (1.38)	3.5 (.14)	8 (.31)	3.1 (.12)
5NA01K		M5 x .8									
6NA01K		M6 x 1.0									
5MA01K			5								
6MA01K			6								
6NA02K		63 (2.48)	M6 x 1.0								
8NA02K	M8 x 1.25										
8MA02K			8								
8NA03K	M8 x 1.25										
10NA03K	78 (3.07)	M10 x 1.5		16 (.63)	21 (.83)	36 (1.42)	8 (.31)	55 (2.17)	4 (.16)	14 (.55)	4.1 (.16)
8MA03K			8								
10MA03K			10								
10NA04K	92 (3.62)	M10 x 1.5		19 (.75)	24 (.94)	43 (1.69)	11 (.43)	65 (2.56)	4 (.16)	17 (.67)	5.1 (.20)
12NA04K		M12 x 1.75									
10MA04K			10								
12MA04K			12								
12NA05K	108 (4.25)	M12 x 1.75		23 (.91)	30 (1.18)	50.5 (1.99)	12 (.47)	76 (2.99)	5 (.20)	23 (.91)	5.1 (.20)
14NA05K		M14 x 2.0									
16NA05K		M16 x 2.0									
12MA05K			12								
16MA05K			16								

1

Adjustable Levers

* For optional-standard colors replace the last digit with the desired suffix: **K** (Matte Black Pebbled Finish), **O** (Orange), **R** (Red), **G** (Gray), **C** (Chrome Plated), **V** (Silver), **Z** (Uncoated). Example of part number for Orange lever: 4NA01O