



RoHS Compliant



3P/B | Three Lobed Knobs

Metric Size • With Tapped Insert

Hand Knob	Black phenolic plastic
Tapped Insert	Brass, molded-in
Diameter A	1.34 – 3.35 inch (34 – 85 mm)
Thread D	M6 – M10

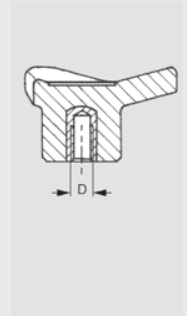
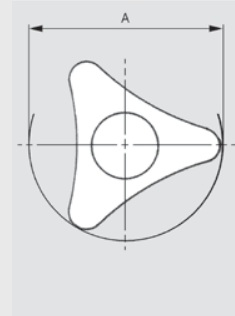

RoHS Compliant



3P/P | Three Lobed Knobs

Metric Size • With Threaded Stud

Hand Knob	Black phenolic plastic
Threaded Stud	Zinc plated steel, molded-in
Diameter A	1.34 – 2.56 inch (34 – 65 mm)
Thread D	M6 – M10
Length L	15 – 40 mm

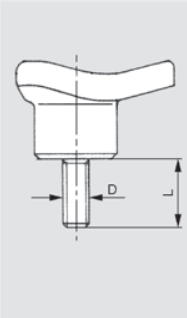
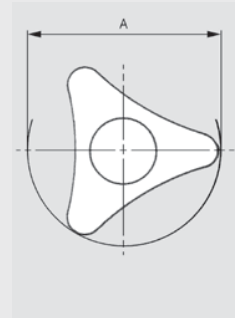

RoHS Compliant



V3/B | Three Lobed Knobs

Metric Size • With Tapped Insert

Hand Knob	Matte black nylon plastic
Tapped Insert	Brass, molded-in
Diameter A	1.77 – 2.17 inch (45 – 55 mm)
Thread D	M6 – M12

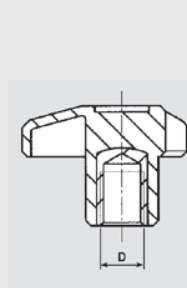
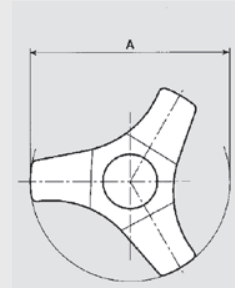

RoHS Compliant



V3/B/FP | Three Lobed Knobs

Metric Size • With Tapped Through Insert

Hand Knob	Matte black nylon plastic
Tapped Insert	Brass, molded-in
Diameter A	1.77 – 2.17 inch (45 – 55 mm)
Thread D	M6 – M12

