

GN 726.2 | Aluminum Knurled Control Knobs

Metric Size • Plain Bore or Collet Type

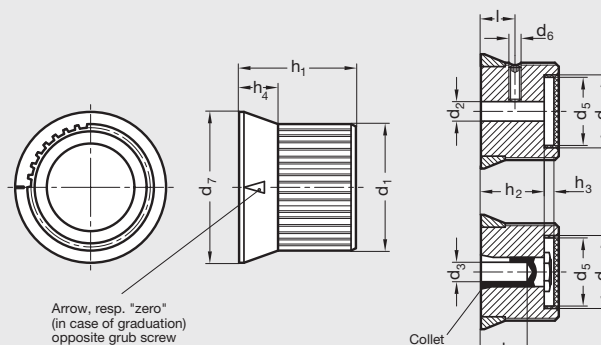

ISO 9001 Supplier

RoHS Compliant

Body

Aluminum, black anodized finish

Skirt

Black plastic

Knob cover disk

Light gray plastic

Socket set screw

Stainless steel with serrated end

Collet and hex nut

Brass

Arrow, graduations and numbers are laser engraved

The light gray cover makes these control knobs GN 726.2 an aesthetically pleasing choice.

The cover is held in place by firmly pushing it into the recess. It can be removed by inserting a screw driver into the slot provided.

The collet type provides a simple way of positioning and locking the control knob to the shaft.

Other types than the standard scale can be supplied, see order examples on How To Order Graduations, page 502.

Control knobs short version without scale rings, see GN 726, page 483.

With Plain Bore and Set Screw

Dimensions in: millimeters (inches)

With Indicator Arrow	Part Number Plain without Graduations or Numbers	With Scale 0...9, 20 Graduations	d ₁	d ₂ (H7) Through Bore	d ₄	d ₅	d ₆ Set Screw Thread	d ₇	h ₁	h ₂	h ₃	h ₄	l
6MF60/A1	6MF60/B1	6MF60/S1	27 (1.06)	6	20 (.79)	18 (.71)	M4 x .7	33.5 (1.32)	26 (1.02)	20 (.79)	4.3 (.17)	9 (.35)	14 (.55)
6MF61/A1	6MF61/B1	6MF61/S1	34 (1.34)	6	25 (.98)	23 (.91)	M5 x .8	41 (1.61)	30 (1.18)	24 (.94)	4.2 (.17)	10 (.39)	15 (.59)
8MF62/A1	8MF62/B1	8MF62/S1	42 (1.65)	8	32 (1.26)	30 (1.18)	M5 x .8	50 (1.97)	34 (1.34)	28 (1.10)	4 (.16)	11 (.43)	16 (.63)
10MF62/A1	10MF62/B1	10MF62/S1		10									

With Collet and Hex Nut

Dimensions in: millimeters (inches)

With Indicator Arrow	Part Number Plain without Graduations or Numbers	With Scale 0...9, 20 Graduations	d ₁	d ₃ Blind Bore	d ₄	d ₅	d ₇	h ₁	h ₂	h ₃	h ₄	t
6ZF60/A2	6ZF60/B2	6ZF60/S2	27 (1.06)	6	20 (.79)	18 (.71)	33.5 (1.32)	26 (1.02)	20 (.79)	4.3 (.17)	9 (.35)	14 (.55)
8ZF61/A2	8ZF61/B2	8ZF61/S2	34 (1.34)	8	25 (.98)	23 (.91)	41 (1.61)	30 (1.18)	24 (.94)	4.2 (.17)	10 (.39)	17 (.67)
10ZF62/A2	10ZF62/B2	10ZF62/S2	42 (1.65)	10	32 (1.26)	30 (1.18)	50 (1.97)	34 (1.34)	28 (1.10)	4 (.16)	11 (.43)	20 (.79)