



**DIN 6337 | Steel Ball Levers**



Metric Size • Blank •  
Tapped or Through Bore Type



**Lever Arm** Steel, black oxide finish, ball knob plastic, DIN 319

**Length  $l_1$**  63 – 160 mm (2.48 – 6.30 inch)

**Diameter  $d_1$**  M8 – M20

**Diameter  $d_2$**  8 – 20 mm

**Types** Angled lever or straight lever

**Blank Type** Solid ball, no flats, no bore

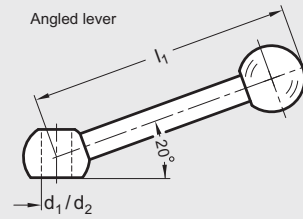

ISO 9001 Supplier

RoHS Compliant



**GN 206 | Iron Clamp Nuts**



Metric Size, Malleable Iron •  
With Tapped Through Holes

**Body** Fettled and tumbled, contact faces machined

**Length  $l$**  56 – 140 mm (2.20 – 5.51 inch)

**Diameter  $d_2$**  M8 – M20

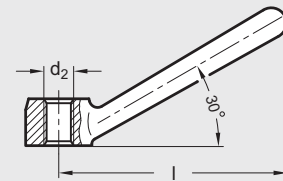

ISO 9001 Supplier

RoHS Compliant



**GN 206.1 | Iron Wing Clamp Nuts**



Metric Size • Malleable Iron •  
With Tapped Through Holes

**Body** Fettled and tumbled, contact faces machined

**Length  $l$**  56 – 140 mm (2.20 – 5.51 inch)

**Diameter  $d_2$**  M8 – M20

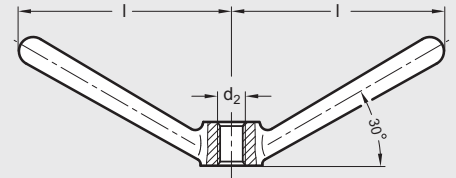

ISO 9001 Supplier

RoHS Compliant



**GN 211 | Steel Control Levers**



With Plain Through Bore • Steel



**Hub and arm** Steel, black oxide finish

**Ball knob** Black phenolic plastic, DIN 319

**Length  $l$**  82 – 138 mm (3.23 – 5.43 inch)

**Diameter  $d_2$**  12 – 20 mm (.472 – .787 inch)

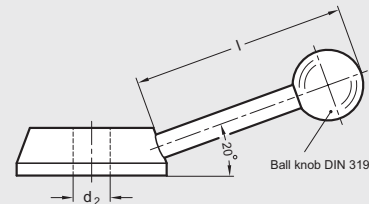

ISO 9001 Supplier

RoHS Compliant