

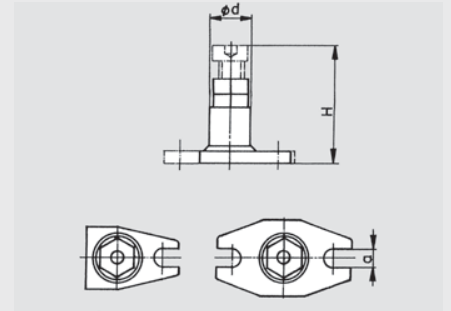

**No. 6430 | Atlas Screw Jacks**

Metric Size • With Jam Nuts

<b>Housing</b>	Cast iron
<b>Spindle Unit</b>	Trapezoidal thread TR 30x6
<b>Slot Width a</b>	18 – 22 mm
<b>Diameter d</b>	50 mm
<b>Height H</b>	140 – 550 mm



ISO 9001 Supplier

RoHS Compliant



**DIN 6314 | Plain Clamps**

Metric Size

<b>Body</b>	Steel, tempered and vanished
<b>Diameter b<sub>1</sub></b>	6.6 – 43 mm
<b>Diameter b<sub>2</sub></b>	20 – 100 mm
<b>Length l</b>	50 – 400 mm

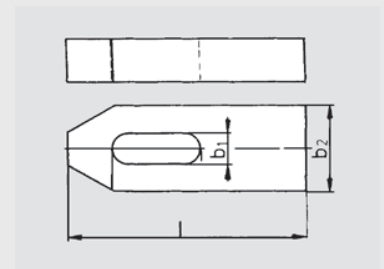

ISO 9001 Supplier

RoHS Compliant



**No. 6314 V | Adjustable Plain Clamps**

Metric Size • With Adjusting Screw

<b>Body</b>	Steel, tempered, black oxide finish
<b>Slot Size a</b>	10 – 28 mm
<b>Length L</b>	80 – 200 mm

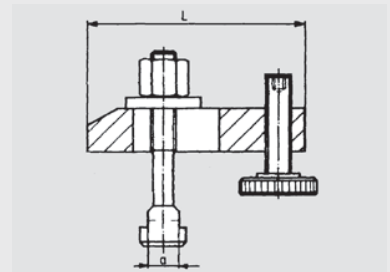

ISO 9001 Supplier

RoHS Compliant



**No. 6314 Z | Step Clamps**

Metric Size

<b>Body</b>	Steel, tempered, enameled finish
<b>Diameter b<sub>1</sub></b>	6.6 – 26 mm
<b>Diameter b<sub>2</sub></b>	20 – 70 mm
<b>Length l</b>	50 – 200 mm

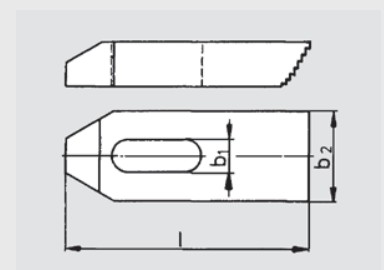

ISO 9001 Supplier

RoHS Compliant