



GN 227.1 | Steel Spoked Handwheels



With Round or Square Bore •
Inch and Metric Size



Body Pressed steel, black powder coated smooth finish

Hub Steel, welded to body

Diameter d_1 4.92 – 15.75 inch
(125 – 400 mm)

Diameter d_2 .500 – 1.00 inch or 11 – 24 mm

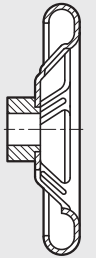
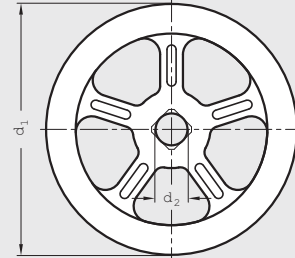

ISO 9001 Supplier

RoHS Compliant



GN 227.2 | Stainless Steel Spoked Handwheels



With or without Revolving Handle •
Inch and Metric Size



Body Pressed 304 stainless steel, shot blasted satin finish



Hub Stainless steel, welded to body

Diameter d_1 6.30 – 9.84 inch (160 – 250 mm)

Diameter d_2 .500 – .750 inch or 12 – 17 mm

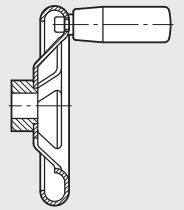
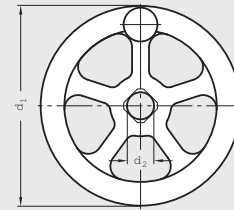

ISO 9001 Supplier

RoHS Compliant



GN 227 | Pressed Steel Valve Handwheels

Metric Size • Square

Body Pressed steel, black or red powder coated smooth finish

Diameter d 1.97 – 6.30 inch (50 – 160 mm)

Square s 6 – 14 mm

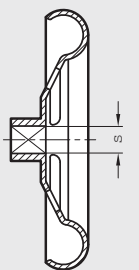
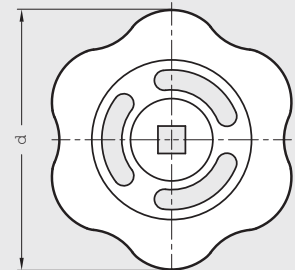

ISO 9001 Supplier

RoHS Compliant



NEW



GN 321.6 | Aluminum Solid Disk Safety Clutch Handwheels



With or without Steel Revolving Handle •
Metric Size



Body Aluminum, gravity die-cast

Rim Turned and highly polished on all sides

Handle GN 598

Diameter d_1 5.51 – 6.30 inch (140 – 160 mm)

Diameter d_2 12 – 16 mm

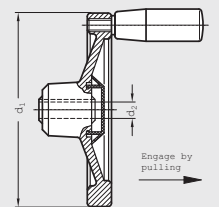
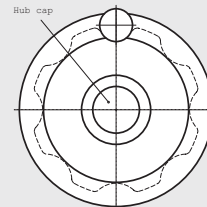

ISO 9001 Supplier

RoHS Compliant

5 Handwheels