

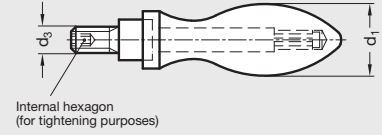

**DIN 98-AL | Aluminum Revolving Handles**

Metric Size

<b>Hand Piece</b>	Aluminum, turned and polished
<b>Spindle</b>	Steel, zinc-plated
<b>Shaft</b>	Available with plain or threaded shaft
<b>Diameter <math>d_1</math></b>	.63 – 1.42 inch (16 – 36 mm)
<b>Diameter <math>d_3</math></b>	M6 – M16



ISO 9001 Supplier

Call for RoHS



**PB/GE | Plastic Revolving Ball Knobs**

Metric Size • Short Shoulder Type

<b>Ball Knob</b>	Revolving, Black phenolic plastic
<b>Spindle</b>	Steel, zinc-plated
<b>Diameter D</b>	1.61 – 2.36 inch (41 – 60 mm)
<b>Diameter d</b>	M8 – M10

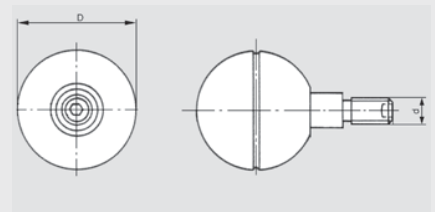

RoHS Compliant



**GN 203 | Plastic Tapered Handles**

Metric Size • With Fixed Threaded Stud

<b>Hand Piece</b>	Black phenolic plastic
<b>Threaded stud</b>	Steel, zinc-plated, molded-in
<b>Diameter <math>d_1</math></b>	.59 – 1.30 inch (15 – 33 mm)
<b>Diameter <math>d_2</math></b>	M5 – M12



ISO 9001 Supplier

RoHS Compliant



**DIN 39-ST | Steel Fixed Handles**

Metric Size • With Fixed Stud

<b>Hand Piece</b>	Steel, turned from solid bar stock and polished
<b>Shaft</b>	Available with plain or threaded shaft
<b>Diameter <math>d_1</math></b>	.63 – 1.42 inch (16 – 36 mm)
<b>Diameter <math>d_3</math></b>	M6 – M16

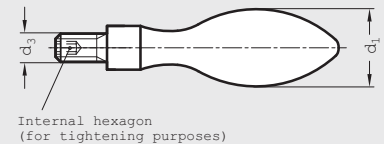

ISO 9001 Supplier

RoHS Compliant