

GN 183 | C-Washers

Metric Size

Body	Steel, case hardened
Diameter d_1	.87 – 2.20 inch (22 – 56 mm)
Diameter b	.24 – .65 inch (6.2 – 16.5 mm)

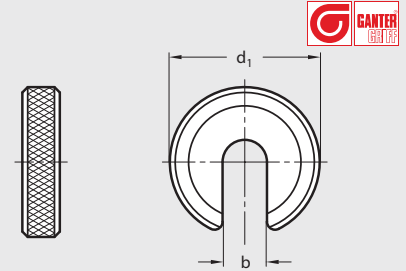

ISO 9001 Supplier

RoHS Compliant



DIN 6371 | Captive C-Washers

Metric Size

Body	Steel, tempered
Diameter d_1	1.50 – 3.82 inch (38 – 97 mm)
Diameter b	.30 – 1.26 inch (7.5 – 32 mm)
Screw	M6 – M8

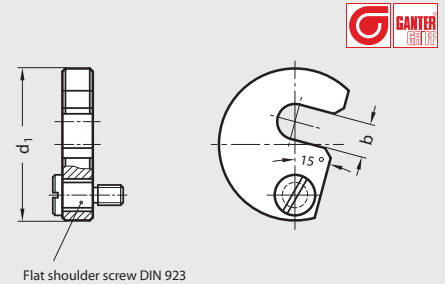

Flat shoulder screw DIN 923

ISO 9001 Supplier

RoHS Compliant



HDCW | Heavy Duty C-Washers

Inch Size

Body	Steel, case hardened
Diameter A	.28 – 1.03 inch (7.1 – 26.2 mm)
Diameter C	1.25 – 3.00 inch (31.8 – 76.2 mm)

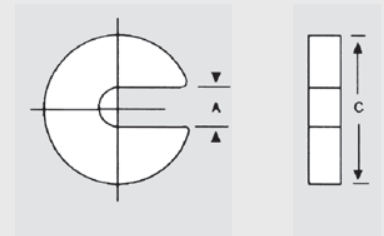

RoHS Compliant



SCW | Swing C-Washers

Inch Size

Body	Steel, hardened
A	1 – 1.75 inch (25.4 – 44.5 mm)
Diameter C	.41 – .78 inch (10.4 – 19.8 mm)

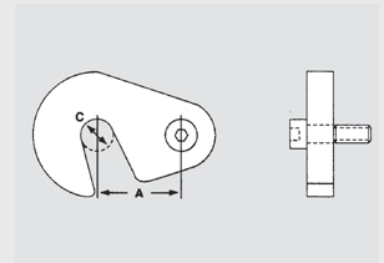

RoHS Compliant