

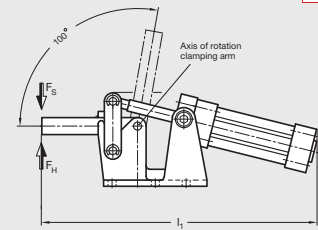

GN 861 | Pneumatic Toggle Clamps

Metric Size • With Horizontal Mounting Base

Toggle Clamp	Steel, zinc plated
Holding	10000 – 20000 N
Capacity	
Length l_1	16.14 – 19.29 inch (410 – 490 mm)



ISO 9001 Supplier

RoHS Compliant



GN 862 | Pneumatic Toggle Clamps

Metric Size • With Vertical Mounting Base

Toggle Clamp	Steel, zinc plated
Holding	2200 – 2700 N
Capacity	
Length l_1	5.91 – 7.40 inch (150 – 188 mm)

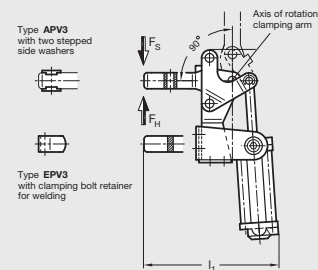

ISO 9001 Supplier

RoHS Compliant



GN 863 | Heavy Duty Pneumatic Lock-Down Toggle Clamps

Metric Size • With Vertical Mounting Base

Toggle Clamp	Steel, zinc plated
Holding	10000 – 20000 N
Capacity	
Length l_1	8.46 – 9.65 inch (215 – 245 mm)

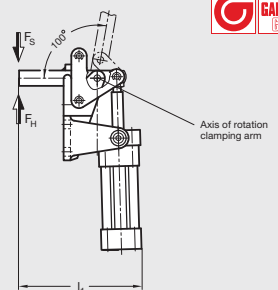

15

ISO 9001 Supplier

RoHS Compliant



GN 890 | Pneumatic Push-Pull Toggle Clamps

Metric Size • With Horizontal Mounting Base

Toggle Clamp	Steel, zinc plated
Holding	1200 – 25000 N
Capacity	
Length l_1	6.77 – 18.43 inch (172 – 460 mm)

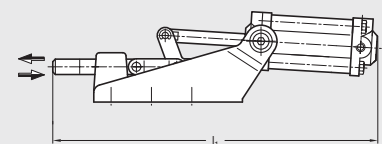

ISO 9001 Supplier

RoHS Compliant

Toggle Clamps