



RoHS Compliant



**3P/B | Three Lobed Knobs**

Metric Size • With Tapped Insert

|                      |                               |
|----------------------|-------------------------------|
| <b>Hand Knob</b>     | Black phenolic plastic        |
| <b>Tapped Insert</b> | Brass, molded-in              |
| <b>Diameter A</b>    | 1.34 – 3.35 inch (34 – 85 mm) |
| <b>Thread D</b>      | M6 – M10                      |

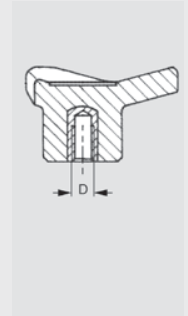
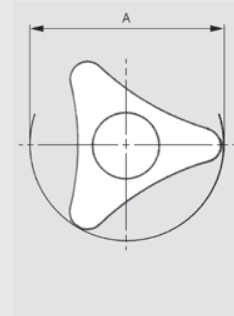

RoHS Compliant



**3P/P | Three Lobed Knobs**

Metric Size • With Threaded Stud

|                      |                               |
|----------------------|-------------------------------|
| <b>Hand Knob</b>     | Black phenolic plastic        |
| <b>Threaded Stud</b> | Zinc plated steel, molded-in  |
| <b>Diameter A</b>    | 1.34 – 2.56 inch (34 – 65 mm) |
| <b>Thread D</b>      | M6 – M10                      |
| <b>Length L</b>      | 15 – 40 mm                    |

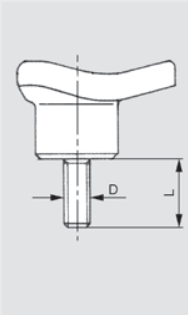
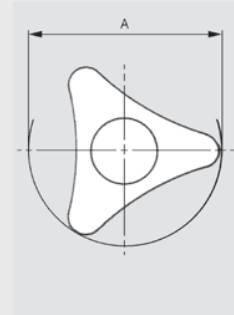

RoHS Compliant



**V3/B | Three Lobed Knobs**

Metric Size • With Tapped Insert

|                      |                               |
|----------------------|-------------------------------|
| <b>Hand Knob</b>     | Matte black nylon plastic     |
| <b>Tapped Insert</b> | Brass, molded-in              |
| <b>Diameter A</b>    | 1.77 – 2.17 inch (45 – 55 mm) |
| <b>Thread D</b>      | M6 – M12                      |

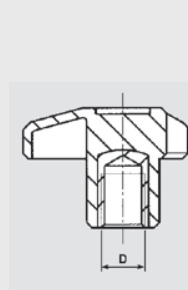
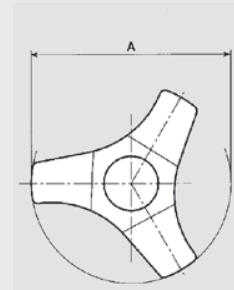

RoHS Compliant



**V3/B/FP | Three Lobed Knobs**

Metric Size • With Tapped Through Insert

|                      |                               |
|----------------------|-------------------------------|
| <b>Hand Knob</b>     | Matte black nylon plastic     |
| <b>Tapped Insert</b> | Brass, molded-in              |
| <b>Diameter A</b>    | 1.77 – 2.17 inch (45 – 55 mm) |
| <b>Thread D</b>      | M6 – M12                      |

