



**GN 227.1 | Steel Spoked Handwheels**



With Round or Square Bore •  
Inch and Metric Size



**Body** Pressed steel, black powder coated smooth finish

**Hub** Steel, welded to body

**Diameter  $d_1$**  4.92 – 15.75 inch  
(125 – 400 mm)

**Diameter  $d_2$**  .500 – 1.00 inch or 11 – 24 mm

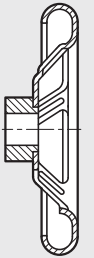
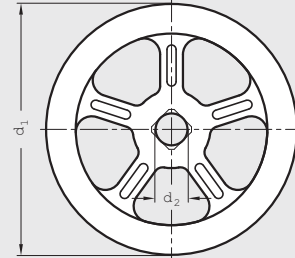

ISO 9001 Supplier

RoHS Compliant



**GN 227.2 | Stainless Steel Spoked Handwheels**



With or without Revolving Handle •  
Inch and Metric Size



**Body** Pressed 304 stainless steel, shot blasted satin finish



**Hub** Stainless steel, welded to body

**Diameter  $d_1$**  6.30 – 9.84 inch (160 – 250 mm)

**Diameter  $d_2$**  .500 – .750 inch or 12 – 17 mm

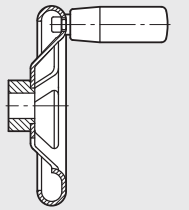
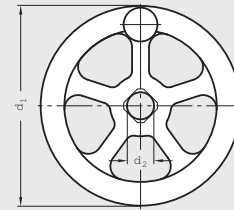

ISO 9001 Supplier

RoHS Compliant



**GN 227 | Pressed Steel Valve Handwheels**

Metric Size • Square

**Body** Pressed steel, black or red powder coated smooth finish

**Diameter  $d$**  1.97 – 6.30 inch (50 – 160 mm)

**Square  $s$**  6 – 14 mm

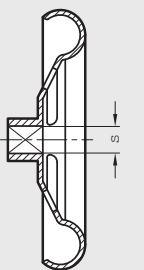
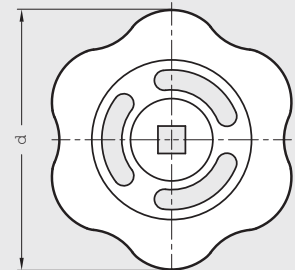

ISO 9001 Supplier

RoHS Compliant



NEW



**GN 321.6 | Aluminum Solid Disk Safety Clutch Handwheels**



With or without Steel Revolving Handle •  
Metric Size



**Body** Aluminum, gravity die-cast

**Rim** Turned and highly polished on all sides

**Handle** GN 598

**Diameter  $d_1$**  5.51 – 6.30 inch (140 – 160 mm)

**Diameter  $d_2$**  12 – 16 mm

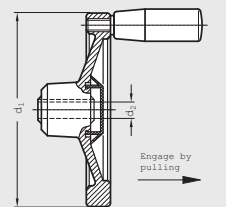
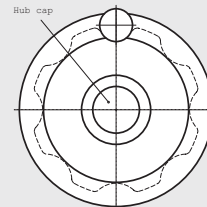

ISO 9001 Supplier

RoHS Compliant