



**EN 500 | Adjustable Plastic Clamping Levers**

Inch Size, Technopolymer • With Tapped Insert



<b>Handle</b>	Technopolymer
<b>Insert</b>	Black oxide steel
<b>Length <math>l_1</math></b>	1.65 – 3.94 inch
<b>Tapped <math>d_1</math></b>	10-24 – 5/8-11
<b>Colors</b>	Black, Orange, Gray

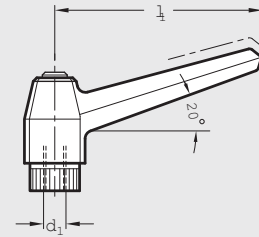

Elesa Model MR.

1

ISO 9001 Supplier

RoHS Compliant



**EN 503.1 | Push Button Plastic Adjustable Levers**

Inch And Metric Size, Stainless Steel • With Tapped Insert



<b>Handle</b>	Technopolymer
<b>Insert</b>	Stainless Steel
<b>Length <math>l_1</math></b>	1.65 – 3.15 inch (42 – 80 mm)
<b>Tapped <math>d_1</math></b>	1/4-20 – 5/16-18 (M 6 – M 10)
<b>Button Colors</b>	Black, Orange, Gray

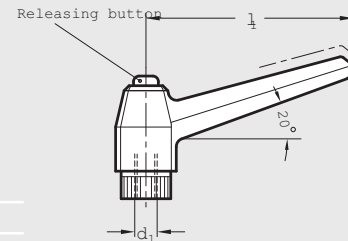

Elesa Model MRX.S

ISO 9001 Supplier

RoHS Compliant



**EN 503.1 | Push Button Plastic Adjustable Levers**

Inch and Metric Size, Stainless Steel • With Threaded Stud



<b>Handle</b>	Technopolymer
<b>Stud</b>	Stainless Steel
<b>Length <math>l_1</math></b>	1.65 – 3.15 inch (42 – 80 mm)
<b>Stud length <math>l_2</math></b>	.50 – 2.00 (16 – 30 mm)
<b>Thread <math>d_1</math></b>	1/4-20 – 3/8-16 (M 6 – M 12)
<b>Button Colors</b>	Black, Orange, Gray

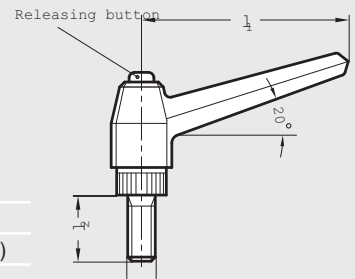

Elesa Model MRX.S-p

ISO 9001 Supplier

RoHS Compliant



**GN 312 | Steel Safety Heavy Duty Adjustable Levers**

Metric Size, Steel • Tapped Type



<b>Handle</b>	Carbon steel, black oxide finish
<b>Ball knob</b>	Black phenolic, DIN 319
<b>Length <math>l</math></b>	2.76 – 4.88 inch (70 – 124 mm)
<b>Tapped <math>d_2</math></b>	M 6 – M 16

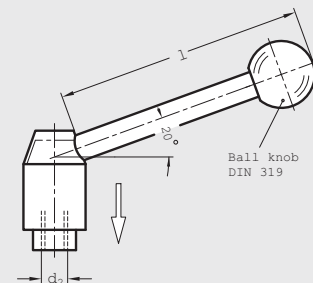

ISO 9001 Supplier

RoHS Compliant