



ISO 9001 Supplier

RoHS Compliant



GN 300.4 | Zinc Die-Cast Adjustable Levers

With secure clamping force • Metric Size • Tapped Type

Handle	Zinc die-cast
Insert	Steel, black oxide finish
Length l_1	63 – 108 mm (2.48 – 4.25 inch)
Tapped d_1	M6 – M12
Colors	Black, Orange, Red, Gray, Chrome plated, Silver, Uncoated

Adjustable levers GN 300.4 are produced with a clamping area which is linked via a thrust pad to the bearing and screw. This design results in doubled clamping force through vastly reduced friction.

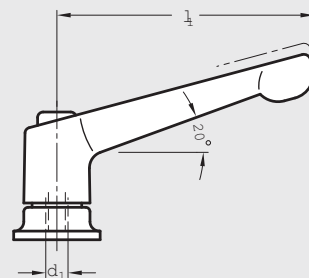

ISO 9001 Supplier

RoHS Compliant



GN 300.4 | Zinc Die-Cast Adjustable Levers

With secure clamping force • Metric Size • Threaded Stud Type

Handle	Zinc die-cast
Insert	Steel, black oxide finish
Length l_1	63 – 108 mm (2.48 – 4.25 inch)
Stud Length l_2	20 – 85 mm (0.78 – 3.34 inch)
Thread d_1	M6 – M12
Colors	Black, Orange, Red, Gray, Chrome plated, Silver, Uncoated

Adjustable levers GN 300.4 are produced with a clamping area which is linked via a thrust pad to the bearing and screw. This design results in doubled clamping force through vastly reduced friction.

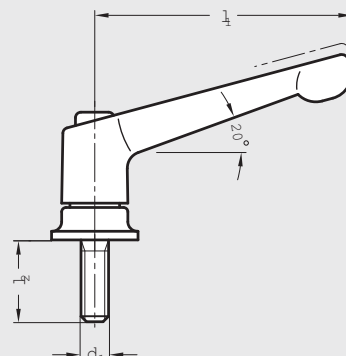

ISO 9001 Supplier

RoHS Compliant



EN 603.1 | Ergostyle® Plastic Adjustable Levers

Inch Size, Plastic • Tapped Type

Handle	Technopolymer
Insert	Stainless Steel with tapped blind hole, molded in
Length l_1	1.73 – 3.07 inch (44 – 78 mm)
Tapped d_1	1/4-20 – 3/8-16
Button Colors	Black, Gray, Yellow, Light Blue, Red

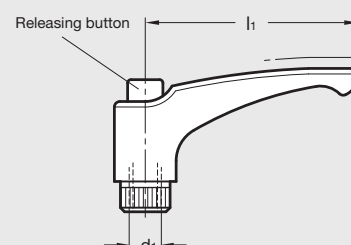

Elesa Model ERX.sst