



ISO 9001 Supplier

RoHS Compliant



### EN 512 | Plastic Control Levers

Technopolymer Plastic



<b>Body</b>	Special glass-fiber reinforced technopolymer plastic, black glossy finish
<b>Hub</b>	Steel, black oxide finish, molded in
<b>Arm</b>	Chrome-plated, matte finish, with phenolic handpiece
<b>Diameter <math>d_1</math></b>	37 – 75 mm (1.46 – 2.95 inch)
<b>Diameter <math>d_2</math></b>	8 – 18 mm (.315 – .709 inch)
<b>Length <math>l</math></b>	81 – 170 mm (3.19 – 6.69 inch)

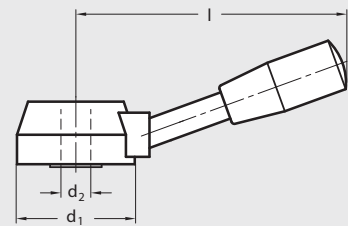

elesa®

Elesa Model LBR



ISO 9001 Supplier

RoHS Compliant



### GN 99.6 | Stainless Steel Clamp Nuts

Metric Size • With Tapped Through Holes



<b>Body</b>	Stainless steel, matte shot blasted satin finish
<b>Length <math>l_1</math></b>	63 – 160 mm (2.48 – 6.30 inch)
<b>Diameter <math>d_1</math></b>	M8 – M20
<b>Shaft</b>	Butt-welded to tapped hub

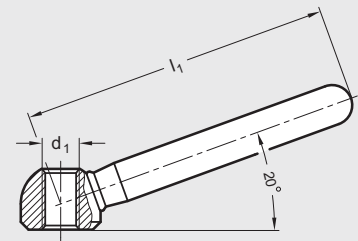

GANTER



ISO 9001 Supplier

RoHS Compliant



### GN 99.8 | Stainless Steel Double Arm Clamp Nuts

Metric Size • Stainless Steel



<b>Body</b>	Stainless steel, matte shot blasted satin finish
<b>Length <math>l</math></b>	47.5 – 118 mm (1.87 – 4.65 inch)
<b>Diameter <math>d_2</math></b>	M8 – M20
<b>Clamp Arms</b>	Butt-welded to tapped hub

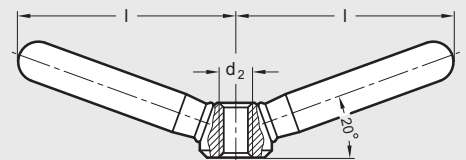

GANTER