

# KHTS | Knurled Toggle Clamp Screws

Inch Size

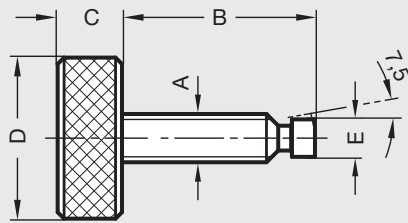

RoHS Compliant

## Knurled screw

Heat treated alloy steel, black oxide finish

## Steel pad

Heat treated alloy steel, black oxide finish

## Delrin® pad

White Delrin® plastic

Screws securely hold parts with off-angle surfaces without marring or damaging the surfaces. For use where finger-tight clamping is adequate, wide knurled head is easy to grip. Available with steel or nylon pads. Pads swivel 7 1/2° in any direction.

## Inch Table

Dimensions in: inches (millimeters)

| Part Number |             | A       | B             | C             | D              | E              | Maximim Load |
|-------------|-------------|---------|---------------|---------------|----------------|----------------|--------------|
| Steel Pad   | Delrin® Pad | Thread  | Stud Length   |               |                |                | (lbs.)       |
| L04-2100    | L04-2142    | 1/4-20  | 1.5<br>(38.1) | .38<br>(9.7)  | 1<br>(25.4)    | .185<br>(4.7)  | 900          |
| L04-2103    | L04-2145    | 1/4-20  | 2<br>(50.8)   | .38<br>(9.7)  | 1<br>(25.4)    | .185<br>(4.7)  | 900          |
| L04-2106    | L04-2148    | 5/16-18 | 1.5<br>(38.1) | .44<br>(11.2) | 1.13<br>(28.7) | .240<br>(6.1)  | 2290         |
| L04-2109    | L04-2151    | 5/16-18 | 2<br>(50.8)   | .44<br>(11.2) | 1.13<br>(28.7) | .240<br>(6.1)  | 2290         |
| L04-2112    | L04-2154    | 5/16-18 | 2.5<br>(63.5) | .44<br>(11.2) | 1.13<br>(28.7) | .240<br>(6.1)  | 2290         |
| L04-2115    | L04-2157    | 3/8-16  | 1.5<br>(38.1) | .5<br>(12.7)  | 1.25<br>(31.8) | .293<br>(7.4)  | 3340         |
| L04-2118    | L04-2160    | 3/8-16  | 2<br>(50.8)   | .5<br>(12.7)  | 1.25<br>(31.8) | .293<br>(7.4)  | 3340         |
| L04-2121    | L04-2163    | 3/8-16  | 2.5<br>(63.5) | .5<br>(12.7)  | 1.25<br>(31.8) | .293<br>(7.4)  | 3340         |
| L04-2124    | L04-2166    | 3/8-16  | 3<br>(76.2)   | .5<br>(12.7)  | 1.25<br>(31.8) | .293<br>(7.4)  | 3340         |
| L04-2127    | L04-2169    | 1/2-13  | 1.5<br>(38.1) | .56<br>(14.2) | 1.25<br>(31.8) | .400<br>(10.2) | 7300         |
| L04-2130    | L04-2172    | 1/2-13  | 2<br>(50.8)   | .56<br>(14.2) | 1.25<br>(31.8) | .400<br>(10.2) | 7300         |
| L04-2133    | L04-2175    | 1/2-13  | 2.5<br>(63.5) | .56<br>(14.2) | 1.25<br>(31.8) | .400<br>(10.2) | 7300         |
| L04-2136    | L04-2178    | 1/2-13  | 3<br>(76.2)   | .56<br>(14.2) | 1.25<br>(31.8) | .400<br>(10.2) | 7300         |