

GN 565.4 | Aluminum Arched Pull Handles

Metric Size • Tapped or Through Holes

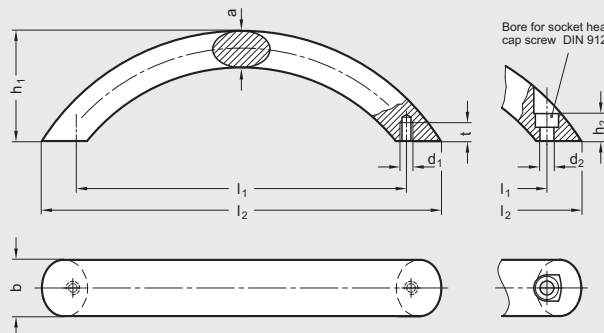

ISO 9001 Supplier

RoHS Compliant

Handle

Aluminum, black powder coated pebble finish (K) or bright tumbled finish version (T)

Mounting holes

Available tapped or with counterbores for socket cap screws

Arch handles GN 565.4 are preferably used for such applications where easy sliding of folding doors or cabinet drawers can be operated with a single finger. Their shape blends well with modern design.

Type B through hole version size 20 accepts inch size 10 – 32 UNC and 10 – 24 UNC and metric size M5 (DIN 912) socket cap screws; size 26 accepts 1/4 – 20 UNC and metric size M6.

Various metric size fasteners and kit packaging available upon request.

Type A – Tapped Hole Version

Dimensions in: millimeters (inches)

Part Number		b	l ₁	d Tapped	l ₂ ~	a	h ₁	t min.
Black Finish	Tumbled Finish							
20W160D18K	20W160D18T	20 (.79)	160 (6.30)	M6 x 1.0	185 (7.28)	13 (.51)	51 (2.00)	8.5 (.33)
20W192D18K	20W192D18T	20 (.79)	192 (7.56)	M6 x 1.0	221 (8.70)	13 (.51)	51 (2.00)	8.5 (.33)
26W160D18K	26W160D18T	26 (1.02)	160 (6.30)	M8 x 1.25	190 (7.48)	17 (.67)	57 (2.24)	11 (.43)
26W192D18K	26W192D18T	26 (1.02)	192 (7.56)	M8 x 1.25	227 (8.94)	17 (.67)	57 (2.24)	11 (.43)

Type B – Through Hole Version

Dimensions in: millimeters (inches)

Part Number		b	l ₁	d ₂ Through Holes	l ₂ ~	a	h ₁	h ₂	t min.
Black Finish	Tumbled Finish								
20W160D19K	20W160D19T	20 (.79)	160 (6.30)	5.3 (.21)	185 (7.28)	13 (.51)	51 (2.00)	10 (.39)	8.5 (.33)
20W192D19K	20W192D19T	20 (.79)	192 (7.56)	5.3 (.21)	221 (8.70)	13 (.51)	51 (2.00)	10 (.39)	8.5 (.33)
26W160D19K	26W160D19T	26 (1.02)	160 (6.30)	6.4 (.25)	190 (7.48)	17 (.67)	57 (2.24)	12 (.47)	11 (.43)
26W192D19K	26W192D19T	26 (1.02)	192 (7.56)	6.4 (.25)	227 (8.94)	17 (.67)	57 (2.24)	12 (.47)	11 (.43)