

KRSK | Stainless Steel Knurled Rim Knobs

Inch Size • With Tapped or Blind Bore

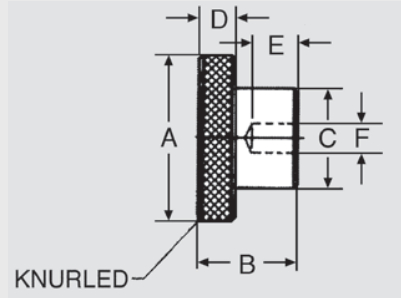

RoHS Compliant

Knob body

Type 303 stainless steel, natural finish
 Machined from solid bar
 Knurled head for non-slip grip
 Bore tol. +.001/-0.003

These knobs are used for applications which require higher durability than plastic or aluminum, yet appearance is essential.

Inch Table

Dimensions in: inches (millimeters)

Part Number	A	F		E Min. Depth	B	C	D
		Tapped	Blind Bore				
2TKR1S	.75 (19.1)	10 – 24		.38 (9.7)	.63 (16.0)	.50 (12.7)	.25 (6.4)
3TKR1S		1/4 – 20					
10BKR1S			.188				
1BKR1S			.250				
3TKR2S	1 (25.4)	1/4 – 20		.50 (12.7)	.75 (19.1)	.63 (16.0)	.25 (6.4)
5TKR2S		5/16 – 18					
1BKR2S			.250				
2BKR2S			.313				
5TKR3S	1.5 (38.1)	5/16 – 18		.63 (16.0)	1 (25.4)	.75 (19.1)	.31 (7.9)
6TKR3S		3/8 – 16					
2BKR3S			.313				
3BKR3S			.375				
6TKR4S	2 (50.8)	3/8 – 16		.63 (16.0)	1.13 (28.7)	1 (25.4)	.38 (9.7)
8TKR4S		1/2 – 13					
3BKR4S			.375				
4BKR4S			.500				
8TKR5S	2.5 (63.5)	1/2 – 13		.75 (19.1)	1.5 (38.1)	1.5 (38.1)	.56 (14.2)
10TKR5S		5/8 – 11					
4BKR5S			.500				
5BKR5S			.625				
10TKR6S	3 (76.2)	5/8 – 11		1 (25.4)	1.75 (44.5)	1.75 (44.5)	.63 (16.0)
11TKR6S		3/4 – 10					
5BKR6S			.625				
6BKR6S			.750				

8

Clamping Knobs