

MB | Bearing Lock Washers

Metric Size

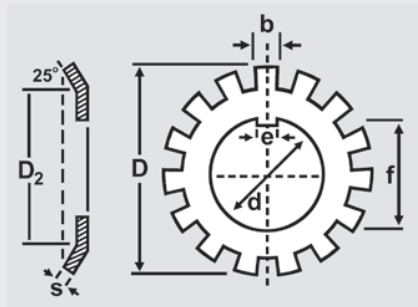
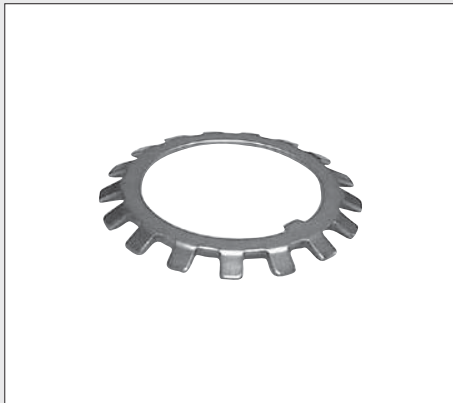

RoHS Compliant

Toothed lock washer

Spring steel, plain finish, DIN 5406

Mainly utilized with KM Bearing Lock Nuts to secure bearings onto a shaft.

Additional sizes available upon request.

Metric Table

Dimensions in: millimeters (*inches*)

Part Number	d	D	D ₂	e	f	s	b	Use with Nut
MB-0	10 (.39)	21 (.83)	13.5 (.53)	3 (.12)	8.5 (.33)	1 (.04)	3 (.12)	KM-0
MB-1	12 (.47)	25 (.98)	17 (.67)	3 (.12)	10.5 (.41)	1 (.04)	3 (.12)	KM-1
MB-2	15 (.59)	28 (1.10)	21 (.83)	4 (.16)	13.5 (.53)	1 (.04)	4 (.16)	KM-2
MB-3	17 (.67)	32 (1.26)	24 (.94)	4 (.16)	15.5 (.61)	1 (.04)	4 (.16)	KM-3
MB-4	20 (.79)	36 (1.42)	26 (1.02)	4 (.16)	18.5 (.73)	1 (.04)	4 (.16)	KM-4
MB-5	25 (.98)	42 (1.65)	32 (1.26)	5 (.20)	23 (.91)	1.25 (.05)	5 (.20)	KM-5
MB-6	30 (1.18)	49 (1.93)	38 (1.50)	5 (.20)	27.5 (1.08)	1.25 (.05)	5 (.20)	KM-6
MB-7	35 (1.38)	57 (2.24)	44 (1.73)	6 (.24)	32.5 (1.28)	1.25 (.05)	5 (.20)	KM-7
MB-8	40 (1.57)	62 (2.44)	50 (1.97)	6 (.24)	37.5 (1.48)	1.25 (.05)	6 (.24)	KM-8
MB-9	45 (1.77)	69 (2.72)	56 (2.20)	6 (.24)	42.5 (1.67)	1.25 (.05)	6 (.24)	KM-9
MB-10	50 (1.97)	74 (2.91)	61 (2.40)	6 (.24)	47.5 (1.87)	1.25 (.05)	6 (.24)	KM-10

13

Joists