

GN 300 | Zinc Die-Cast Adjustable Levers

With Steel Components • Threaded Stud Type • Inch and Metric Size

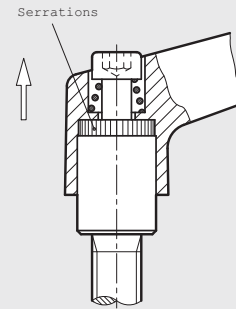
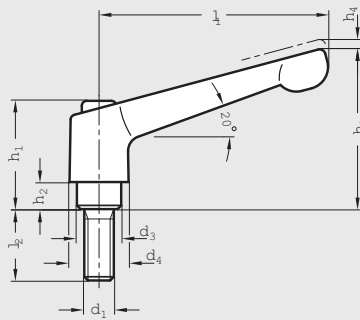

1

Adjustable Levers

ISO 9001 Supplier

RoHS Compliant

Handle

Zinc die-cast

Threaded insert, screw and spring

Steel, black oxide finish

Standard colors

- K** Matte Black Pebbled Finish, electrostatically applied powder coat
- O** Orange
- R** Red
- G** Gray
- C** Chrome Plated
- V** Silver
- Z** Uncoated

Adjustable hand levers GN 300 are the result of modern industrial design.

All such levers have proven to be ideal whenever parts have to be clamped in a confined space or in a particular lever position. The insert is connected to the lever via serrations which can easily be disengaged.

Pulling the lever upwards, disengages the serrations, allowing it to be swivelled to the ideal clamping position. When releasing the lever, the serrations automatically re-engage.

Special threads and stud lengths are available upon request.

For certain minimum quantities, special colors also available upon request.

Inch Table

Dimensions in: inches (millimeters)

Part Number Black	l_1	d_1 Thread	l_2 Stud Length	d_3	d_4	h_1	h_2	h_3	h_4
1T10A19K	1.18 (30)	10-32	.39	.39 (10)	.49 (12.5)	1.04 (26.5)	.16 (4)	1.38 (35)	.14 (3.5)
1T12A19K			.47						
1T16A19K			.63						
1T20A19K			.78						
1T25A19K			.98						
1T32A19K			1.26						
2T12A19K		10-24	.47						
2T16A19K			.63						
2T20A19K			.78						
2T25A19K			.98						
2T32A19K			1.26						
3T10A19K			1/4-20						
3T12A19K		.47							
3T16A19K		.63							
3T20A19K		.78							
3T25A19K		.98							
3T32A19K		1.26							
3T40A19K		1.57							
3T45A19K		1.77							

Table continued...

* For optional-standard colors replace the last digit with the desired suffix: **K** (Matte Black Pebbled Finish), **O** (Orange), **R** (Red), **G** (Gray), **C** (Chrome Plated), **V** (Silver), **Z** (Uncoated). Example of part number for Orange lever: 1T10A01O



Dimensions in: inches (millimeters)

Part Number Black	l ₁	d ₁ Thread	l ₂ Stud Length	d ₃	d ₄	h ₁	h ₂	h ₃	h ₄																			
1T10A01K	1.77 (45)	10-32	.39	.39 (10)	.51 (13)	.96 (24.5)	.16 (4)	1.38 (35)	.14 (3.5)																			
1T12A01K			.47																									
1T16A01K			.63																									
1T20A01K			.78																									
1T25A01K			.98																									
1T32A01K			1.26																									
2T12A01K		10-24	.47																									
2T16A01K			.63																									
2T20A01K			.78																									
2T25A01K			.98																									
2T32A01K			1.26																									
3T10A01K			1/4-20													.39												
3T12A01K		.47																										
3T16A01K		.63																										
3T20A01K		.78																										
3T25A01K		.98																										
3T32A01K		1.26																										
3T40A01K		1.57																										
3T45A01K		1.77																										
3T12A02K	2.48 (63)	1/4-20	.47	.53 (13.5)	.69 (17.5)	1.22 (31)	.26 (6.5)	1.77 (45)	.16 (4)																			
3T16A02K			.63																									
3T20A02K			.78																									
3T25A02K			.98																									
5T12A02K			5/16-18													.47												
5T16A02K																.63												
5T20A02K		.78																										
5T25A02K		.98																										
5T32A02K		1.26																										
5T40A02K		1.57																										
5T45A02K		1.77																										
5T50A02K		1.97																										
5T63A02K		2.48																										
6T16A02K		3/8-16	.63																									
6T20A02K			.78																									
6T25A02K			.98																									
6T32A02K			1.26																									
6T40A02K			1.57																									
6T45A02K			1.77																									
6T50A02K	1.97																											
6T63A02K	2.48																											
6T16A03K	3.07 (78)	3/8-16	.63	.63 (16)	.83 (21)	1.42 (36)	.31 (8)	2.17 (55)	.16 (4)																			
6T20A03K			.78																									
6T25A03K			.98																									
6T32A03K			1.26																									
6T40A03K			1.57																									
6T45A03K			1.77																									
6T50A03K			1.97																									
6T63A03K	2.48																											

Table continued...

* For optional-standard colors replace the last digit with the desired suffix: **K** (Matte Black Pebbled Finish), **O** (Orange), **R** (Red), **G** (Gray), **C** (Chrome Plated), **V** (Silver), **Z** (Uncoated). Example of part number for Orange lever: 1T10A01O

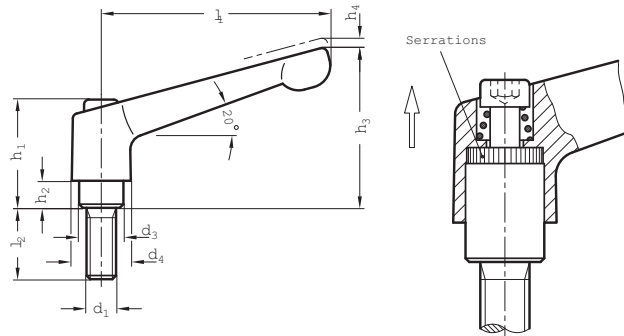

1 Adjustable Levers

Dimensions in: inches (millimeters)

Part Number Black	l ₁	d ₁ Thread	l ₂ Stud Length	d ₃	d ₄	h ₁	h ₂	h ₃	h ₄
8T16A03K	3.07 (78)	1/2-13	.63	.63 (16)	.83 (21)	1.42 (36)	.31 (8)	2.17 (55)	.16 (4)
8T20A03K			.78						
8T25A03K			.98						
8T32A03K			1.26						
8T40A03K			1.57						
8T45A03K			1.77						
8T50A03K	1.97								
6T16A04K	3.62 (92)	3/8-16	.63	.75 (19)	.94 (24)	1.69 (43)	.43 (11)	2.56 (65)	.16 (4)
6T20A04K			.78						
6T25A04K			.98						
6T32A04K			1.26						
6T40A04K			1.57						
6T45A04K			1.77						
6T50A04K		1.97							
6T63A04K		2.48							
8T16A04K		1/2-13	.63						
8T20A04K			.78						
8T25A04K			.98						
8T32A04K			1.26						
8T35A04K			1.38						
8T40A04K			1.57						
8T45A04K		1.77							
8T50A04K		1.97							
8T63A04K		2.48							
8T25A05K		4.25 (108)	1/2-13						
8T32A05K	1.26								
8T40A05K	1.57								
8T50A05K	1.97								
8T55A05K	2.17								
8T63A05K	2.48								
10T32A05K	5/8-11		1.26						
10T40A05K			1.57						
10T50A05K			1.97						
10T55A05K			2.17						
10T63A05K	2.48								

* For optional-standard colors replace the last digit with the desired suffix: **K** (Matte Black Pebbled Finish), **O** (Orange), **R** (Red), **G** (Gray), **C** (Chrome Plated), **V** (Silver), **Z** (Uncoated). Example of part number for Orange lever: 1T10A01O



Metric Table

Dimensions in: millimeters (*inches*)

Part Number Black	l ₁	d ₁ Thread	l ₂ Stud Length	d ₃	d ₄	h ₁	h ₂	h ₃	h ₄																									
3N10A19K	30 (1.18)	M3 x .5	10	10 (.39)	12 (.49)	26.5 (1.04)	4 (.16)	35 (1.38)	3.5 (.14)																									
3N12A19K			12																															
3N16A19K			16																															
3N20A19K			20																															
3N25A19K			25																															
3N32A19K			32																															
4N10A19K		M4 x .7	10							10 (.39)	12 (.49)	26.5 (1.04)	4 (.16)	35 (1.38)	3.5 (.14)																			
4N12A19K			12																															
4N16A19K			16																															
4N20A19K			20																															
4N25A19K			25																															
4N32A19K			32																															
5N12A19K		M5 x .8	12													10 (.39)	12 (.49)	26.5 (1.04)	4 (.16)	35 (1.38)	3.5 (.14)													
5N16A19K			16																															
5N20A19K			20																															
5N25A19K			25																															
5N32A19K			32																															
5N40A19K			40																															
5N50A19K			50																															
6N10A19K			M6 x 1.0																			10	10 (.39)	12 (.49)	26.5 (1.04)	4 (.16)	35 (1.38)	3.5 (.14)						
6N12A19K		12																																
6N16A19K		16																																
6N20A19K		20																																
6N25A19K		25																																
6N32A19K		32																																
6N40A19K		40																																
6N45A19K		45																																
6N50A19K		50																																
4N10A01K		45 (1.77)																				M4 x .7							10	10 (.39)	13 (.51)	24.5 (.96)	4 (.16)	35 (1.38)
4N12A01K			12																															
4N16A01K	16																																	
4N20A01K	20																																	
4N25A01K	25																																	
4N32A01K	32																																	
5N12A01K	M5 x .8		12	10 (.39)	13 (.51)	24.5 (.96)	4 (.16)	35 (1.38)	3.5 (.14)																									
5N16A01K			16																															
5N20A01K			20																															
5N25A01K			25																															
5N32A01K			32																															
5N40A01K			40																															
5N50A01K			50																															
6N10A01K			M6 x 1.0							10	10 (.39)	13 (.51)	24.5 (.96)	4 (.16)	35 (1.38)							3.5 (.14)												
6N12A01K	12																																	
6N16A01K	16																																	
6N20A01K	20																																	
6N25A01K	25																																	
6N32A01K	32																																	
6N40A01K	40																																	
6N45A01K	45																																	
6N50A01K	50																																	

1
Adjustable Levers

Table continued...

* For optional-standard colors replace the last digit with the desired suffix: **K** (Matte Black Pebbled Finish), **O** (Orange), **R** (Red), **G** (Gray), **C** (Chrome Plated), **V** (Silver), **Z** (Uncoated). Example of part number for Orange lever: 4N12A01O

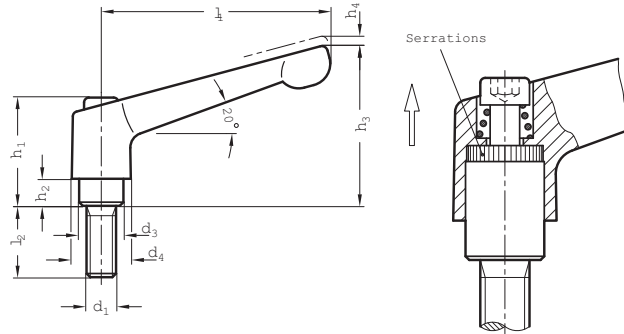

1

Adjustable Levers

Dimensions in: millimeters (inches)

Part Number Black	l_1	d_1 Thread	l_2 Stud Length	d_3	d_4	h_1	h_2	h_3	h_4	
6N12A02K	63 (2.48)	M6 x 1.0	12	13.5 (.53)	17.5 (.69)	31 (1.22)	6.5 (.26)	45 (1.77)	4 (.16)	
6N16A02K			16							
6N20A02K			20							
6N25A02K			25							
6N32A02K			32							
6N40A02K			40							
6N50A02K			50							
6N63A02K		63								
8N12A02K		63 (2.48)	M8 x 1.25							12
8N16A02K										16
8N20A02K										20
8N25A02K										25
8N32A02K										32
8N40A02K										40
8N45A02K	45									
8N50A02K	50									
8N63A02K	63									
10N16A02K	63 (2.48)		M10 x 1.5	16						
10N20A02K				20						
10N25A02K				25						
10N32A02K				32						
10N40A02K				40						
10N45A02K		45								
10N50A02K		50								
10N63A02K		63								
10N80A02K		80								
8N16A03K		78 (3.07)		M8 x 1.25	16					
8N20A03K					20					
8N25A03K					25					
8N32A03K					32					
8N40A03K					40					
8N45A03K	45									
8N50A03K	50									
8N63A03K	63									
8N80A03K	80									

Table continued...

* For optional-standard colors replace the last digit with the desired suffix: **K** (Matte Black Pebbled Finish), **O** (Orange), **R** (Red), **G** (Gray), **C** (Chrome Plated), **V** (Silver), **Z** (Uncoated). Example of part number for Orange lever: 4N12A01O



Dimensions in: millimeters (*inches*)

Part Number Black	h ₁	d ₁ Thread	l ₂ Stud Length	d ₃	d ₄	h ₁	h ₂	h ₃	h ₄								
10N16A03K	78 (3.07)	M10 x 1.5	16	16 (.63)	21 (.83)	36 (1.42)	8 (.31)	55 (2.17)	4 (.16)								
10N20A03K			20														
10N25A03K			25														
10N32A03K			32														
10N40A03K			40														
10N45A03K			45														
10N50A03K			50														
10N63A03K			63														
10N80A03K		80															
12N25A03K		M12 x 1.75	25														
12N32A03K			32														
12N40A03K			40														
12N50A03K			50														
12N63A03K			63														
12N80A03K			80														
10N16A04K			92 (3.62)							M10 x 1.5	16	19 (.75)	24 (.94)	43 (1.69)	11 (.43)	65 (2.56)	4 (.16)
10N20A04K	20																
10N25A04K	25																
10N32A04K	32																
10N40A04K	40																
10N45A04K	45																
10N50A04K	50																
10N63A04K	63																
10N80A04K	80																
12N16A04K	M12 x 1.75	16															
12N20A04K		20															
12N25A04K		25															
12N32A04K		32															
12N35A04K		35															
12N40A04K		40															
12N45A04K		45															
12N50A04K		50															
12N63A04K		63															
12N80A04K		80															
16N25A04K		M16 x 2.0		25													
16N32A04K				32													
16N40A04K				40													
16N50A04K				50													
16N63A04K				63													
16N80A04K				80													
12N25A05K	108 (4.25)			M12 x 1.75	25	23 (.91)	30 (1.18)	50.5 (1.99)	12 (.47)	76 (2.99)	5 (.20)						
12N32A05K					32												
12N40A05K		40															
12N50A05K		50															
12N63A05K		63															
12N80A05K		80															
12N120A05K		120															
16N25A05K		M16 x 2.0	25														
16N32A05K			32														
16N40A05K			40														
16N50A05K			50														
16N63A05K			63														
16N80A05K			80														
16N120A05K			120														

1
Adjustable Levers

* For optional-standard colors replace the last digit with the desired suffix: **K** (Matte Black Pebbled Finish), **O** (Orange), **R** (Red), **G** (Gray), **C** (Chrome Plated), **V** (Silver), **Z** (Uncoated). Example of part number for Orange lever: 4N12A01O