

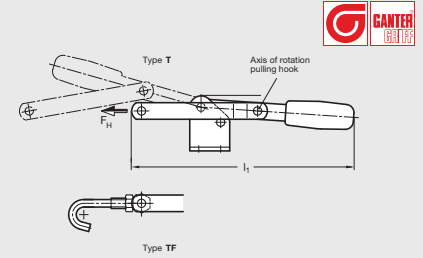

GN 850 | Hook Type Toggle Clamps

Metric Size

Body	Steel, zinc plated
Versions	With draw axle or draw hook
Holding	2000 – 4000 N
Capacity	
Length I₁	7.95 – 10.75 inch (202 – 273 mm)



ISO 9001 Supplier

RoHS Compliant



6847-NI | Hook-Type Toggle Clamps



Metric Size

Toggle Clamp	Stainless steel
Holding	1000 – 2500 N
Capacity	
Length I	81-86 – 202-214 mm

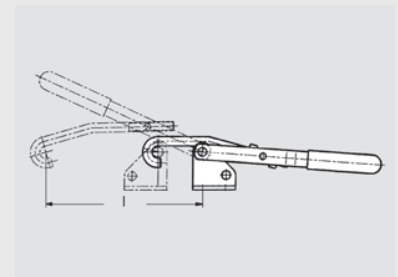

ISO 9001 Supplier



6847-GNI | Fixed Catch



Metric Size • for Hook-Type Toggle Clamps

Catch Body	Stainless steel
Length I	41 – 88 mm

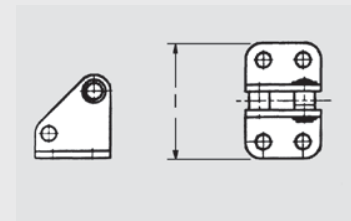

ISO 9001 Supplier



GN 860 | Pneumatic Toggle Clamps

Metric Size • With Horizontal Mounting Base

Toggle Clamp	Steel, zinc plated
Versions	U-bar with two flanged washers or solid bar with clasp
Holding	700 – 3000 N
Capacity	
Length I₁	6.42 – 14.17 inch (163 – 360 mm)

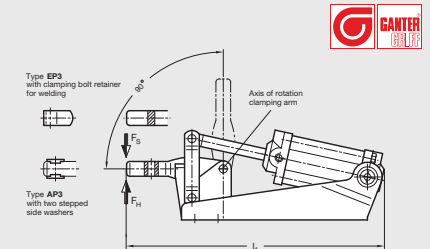

ISO 9001 Supplier

RoHS Compliant