

GN 324 | Aluminum-Two Spoked Handwheels

Inch and Metric Size • With or without Revolving Handle

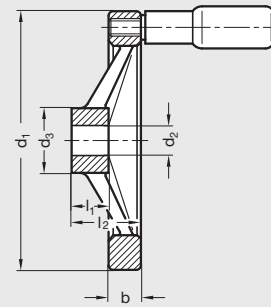
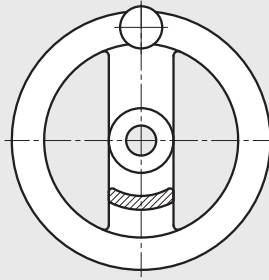

ISO 9001 Supplier

RoHS Compliant

5

Handwheels

Handwheel body

Aluminum, gravity die-cast with matte black powder coated pebble finish

Contact face of hub machined

Handwheel rim

Turned, rim is concentric and square to bore

Revolving handle

Black nylon plastic hand piece with zinc-plated steel threaded spindle, GN 798, page 176.

No mounting hole in handwheel rim for handwheel without handle

Handle shipped loose; mounting of handle is required

Handwheels GN 324 have the same dimensions as GN 322. A slight pebble finish provides an even finish all over. Countersunk washers for handwheel retention, see GN 184, page 661. Handwheels with rim highly polished, see GN 322, page 235. Special inch and metric bores are available upon request. Other modifications such as keyways, set screw holes, etc. available upon request.

Inch Table

Dimensions in: inches (millimeters)

| Part Number | | d ₁ | d ₂ Through Bore | d ₃ | b | l ₁ | l ₂ | Handle Diameter | Handle Thread | Handle Length |
|-------------|----------------|----------------|--------------------------------|----------------|---------------|----------------|----------------|-----------------|---------------|---------------|
| With Handle | Without Handle | | | | | | | | | |
| 4BF18/R | 4BF18/A | 4.92 (125) | .500 | 1.22 (31) | .59 (15) | .71 (18) | 1.30 (33) | .87 (22) | M8 x 1.25 | 2.32 (59) |
| 5BF19/R | 5BF19/A | 5.51 (140) | .625 | 1.42 (36) | .65 (16.5) | .75 (19) | 1.42 (36) | .87 (22) | M8 x 1.25 | 2.32 (59) |
| 4BF20/R | 4BF20/A | 6.30 (160) | .500 | 1.42 (36) | .71 (18) | .79 (20) | 1.54 (39) | .94 (24) | M10 x 1.5 | 2.91 (74) |
| 5BF21/R | 5BF21/A | 7.87 (200) | .625 | 1.65 (42) | .81 (20.5) | .94 (24) | 1.77 (45) | .94 (24) | M10 x 1.5 | 2.91 (74) |
| 6BF21/R | 6BF21/A | 7.87 (200) | .750 | 1.65 (42) | .81 (20.5) | .94 (24) | 1.77 (45) | .94 (24) | M10 x 1.5 | 2.91 (74) |
| 8BF22/R | 8BF22/A | 9.84 (250) | .875 | 1.89 (48) | .91 (23) | 1.10 (28) | 2.01 (51) | .98 (25) | M10 x 1.5 | 3.31 (84) |

Metric Table

Dimensions in: millimeters (inches)

| Part Number | | d ₁ | d ₂ Through Bore | d ₃ | b | l ₁ | l ₂ | Handle Diameter | Handle Thread | Handle Length |
|-------------|----------------|----------------|--------------------------------|----------------|---------------|----------------|----------------|-----------------|---------------|---------------|
| With Handle | Without Handle | | | | | | | | | |
| 12MF18/R | 12MF18/A | 125 (4.92) | 12 | 31 (1.22) | 15 (.59) | 18 (.71) | 33 (1.30) | 22 (.87) | M8 x 1.25 | 59 (2.32) |
| 14MF19/R | 14MF19/A | 140 (5.51) | 14 | 36 (1.42) | 16.5 (.65) | 19 (.75) | 36 (1.42) | 22 (.87) | M8 x 1.25 | 59 (2.32) |
| 12MF20/R | 12MF20/A | 160 (6.30) | 12 | 36 (1.42) | 18 (.71) | 20 (.79) | 39 (1.54) | 24 (.94) | M10 x 1.5 | 74 (2.91) |
| 14MF20/R | 14MF20/A | | 14 | | | | | | | |
| 18MF21/R | 18MF21/A | 200 (7.87) | 18 | 42 (1.65) | 20.5 (.81) | 24 (.94) | 45 (1.77) | 24 (.94) | M10 x 1.5 | 74 (2.91) |
| 22MF22/R | 22MF22/A | 250 (9.84) | 22 | 48 (1.89) | 23 (.91) | 28 (1.10) | 51 (2.01) | 25 (.98) | M10 x 1.5 | 84 (3.31) |