



DIN 6337 | Steel Ball Levers



Metric Size • Blank •
Tapped or Through Bore Type



Lever Arm Steel, black oxide finish, ball knob plastic, DIN 319

Length l_1 63 – 160 mm (2.48 – 6.30 inch)

Diameter d_1 M8 – M20

Diameter d_2 8 – 20 mm

Types Angled lever or straight lever

Blank Type Solid ball, no flats, no bore

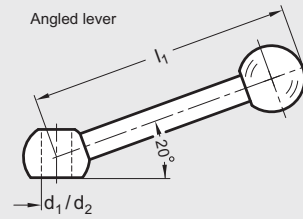

ISO 9001 Supplier

RoHS Compliant



GN 206 | Iron Clamp Nuts

Metric Size, Malleable Iron •
With Tapped Through Holes

Body Fettled and tumbled, contact faces machined

Length l 56 – 140 mm (2.20 – 5.51 inch)

Diameter d_2 M8 – M20

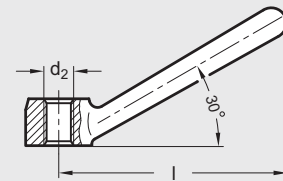

ISO 9001 Supplier

RoHS Compliant



GN 206.1 | Iron Wing Clamp Nuts

Metric Size • Malleable Iron •
With Tapped Through Holes

Body Fettled and tumbled, contact faces machined

Length l 56 – 140 mm (2.20 – 5.51 inch)

Diameter d_2 M8 – M20

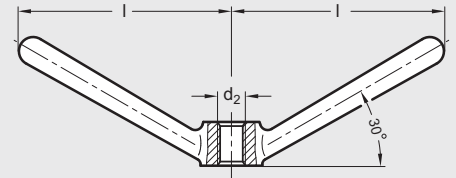

ISO 9001 Supplier

RoHS Compliant



GN 211 | Steel Control Levers

With Plain Through Bore • Steel



Hub and arm Steel, black oxide finish



Ball knob Black phenolic plastic, DIN 319

Length l 82 – 138 mm (3.23 – 5.43 inch)

Diameter d_2 12 – 20 mm (.472 – .787 inch)

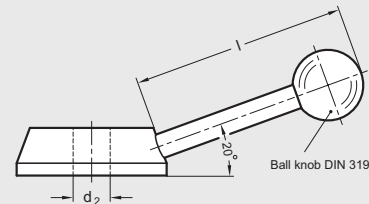

ISO 9001 Supplier

RoHS Compliant