

GP | Nylon Plastic Wing Screws

Metric Size

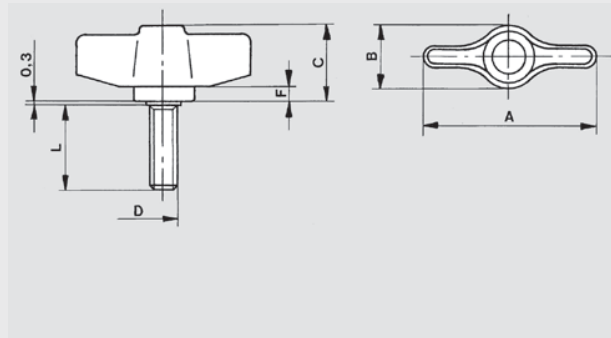

RoHS Compliant

Wing body

Matte black, glass filled nylon plastic

Threaded stud

Zinc plated steel, molded-in

Plastic wing nuts with tapped insert, see GB, page 435.

Maximum heat resistance of nylon plastic: 110°C (230°F).

Plastic wing nuts with tapped through hole insert, see GB/FP, page 436.

Metric Table

Dimensions in: millimeters (*inches*)

Part Number	A	D Thread	L Stud Length	B	C	F
6310050	34 (1.34)	M6 x 1.0	10	14 (.55)	18 (.71)	4 (.16)
6310055			15			
6310060			20			
6310065			25			
6310070		M8 x 1.25	10			
6310075			15			
6310080			20			
6310085	48 (1.89)	M6 x 1.0	25	17 (.67)	20 (.79)	4 (.16)
6310003			10			
6310005			15			
6310007			20			
6310008		25				
6310010		M8 x 1.25	10			
6310015			15			
6310020			20			
6310022			25			
6310023			30			
6310025	35					
6310028	40					

8

Clamping Knobs