

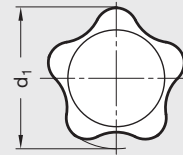

EN 5337.5 | Solid Five Lobed Knobs

Inch Size • With Threaded Stud

Hand Knob	Technopolymer plastic
Insert	Steel, zinc-plated
Diameter d_1	1.26 – 2.36 inch (32 – 60 mm)
Thread d_2	1/4 -20 – 1/2 -13
Length l	.75 – 1.5 inch



Elesa Model VC.692 p

ISO 9001 Supplier

RoHS Compliant



NEW



EN 5337.6 | Softline Star Knobs

Inch and Metric Size • With Tapped Brass Insert

Knob Core	Technopolymer plastic
Knob Rim	Soft elastomer plastic
Insert	Brass, molded-in
Diameter d_1	1.69 – 2.09 inch (43 – 53 mm)
Thread d_2	5/16-18 – 3/8-16 or M8 – M10

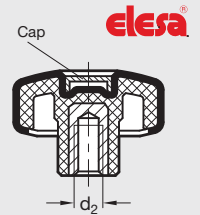
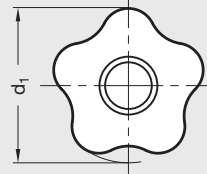

Elesa Model VCT.-SOFT

ISO 9001 Supplier

RoHS Compliant



NEW



EN 5337.6 | Softline Star Knobs

Inch and Metric Size • With Threaded Stud

Knob Core	Technopolymer plastic
Knob Rim	Soft elastomer plastic
Insert	Zinc plated, blue passivated
Diameter d_1	1.69 – 2.09 inch (43 – 53 mm)
Thread d_2	5/16-18 – 3/8-16 or M8 – M10
Length l	1.0 – 1.5 mm or 16 – 30 mm

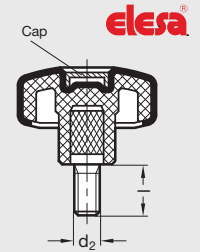
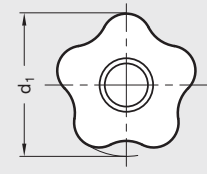

Elesa Model VCTp.-SOFT

ISO 9001 Supplier

RoHS Compliant



WD 497 | Soft Touch Five Lobed Knobs

Inch Size • With Tapped Insert

Hand Knob	Matte black two-shot soft thermoplastic
Tapped Insert	Brass, molded-in
Diameter A	1.50 – 2.38 inch (38 – 60 mm)
Thread	1/4-20 – 3/8-16

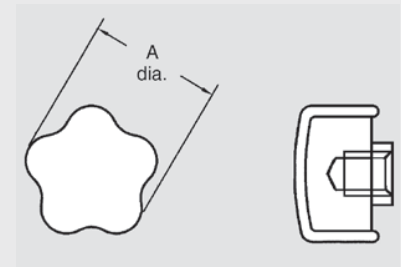

ISO 9001 Supplier

RoHS Compliant