

GN 6339 | Steel Heavy Duty Washers

Metric Size

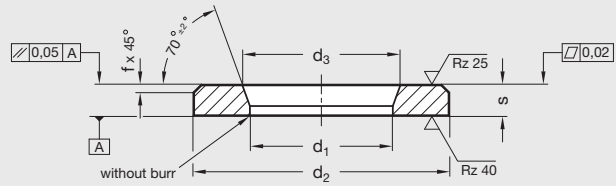

NEW



ISO 9001 Supplier

RoHS Compliant

Washer body

Steel, 42CrMoS4V, Material-No. 1.7227, case hardened to tensile strength $R_m = 1220 - 1400$ N/mm², fine machined and fine ground
 Type BT – Blackened finish
 Type GO – GEOMET 500 coating (integrated aluminum/zinc)

Available in high and low types

The effect of a washer on the quality of a threaded connection is often underestimated. GN 6339 washers provide a high quality connection. High static clamping force can be achieved without loss of tension. At a specified preloaded clamping force, it is often possible to use thinner bolts. This can result in a better ratio between clamping distance and bolt diameter, minimizing the danger of failure.

The case-hardened, smooth bolt head/screw contact face results in a lower and more constant friction co-efficient, even when continuous clamping and releasing is required. GN 6339 washers are suitable only for machine construction bolts of classes 8.8 / 10.9 / 12.9, and not for DIN 6916 steel bolts.

High Type

Dimensions in: inches (millimeters)

Part Number		d ₁ h ₁₃	d ₂ h ₁₃	s ±.2mm	d ₃ H ₁₃	f ±.2mm High Type	Fits Metric Bolt Size
Type BT	Type GO						
6M17FBCK	6M17FBC/G5	6.3	17	3	7	1	M6
8M21FBCK	8M21FBC/G5	8.4	21	4	9.5	1.5	M8
10M25FBCK	10M25FBC/G5	10.4	25	4	11.5	1.5	M10
12M30FBCK	12M30FBC/G5	12.5	30	6	14	2	M12
14M36FBCK	14M36FBC/G5	14.5	36	6	16	2	M14
16M40FBCK	16M40FBC/G5	16.5	40	6	18	2	M16
18M44FBCK	18M44FBC/G5	18.5	44	8	21	2.5	M18
20M44FBCK	20M44FBC/G5	20.5	44	8	23	2.5	M20
22M50FBCK	22M50FBC/G5	22.5	50	8	25	2.5	M22
24M50FBCK	24M50FBC/G5	24.5	50	10	27	3.5	M24
27M60FBCK	27M60FBC/G5	28	60	10	31	3.5	M27
30M68FBCK	30M68FBC/G5	31	68	10	34	3.5	M30

11

Jig, Fixture and Fastening Components



Low Type

Dimensions in: inches (millimeters)

Part Number		d ₁ h ₁₃	d ₂ h ₁₃	s ±.2mm	d ₃ H ₁₃	f ±.2mm Low Type	Fits Metric Bolt Size
Type BT	Type GO						
6M12FBDK	6M12FBD/G5	6.3	12	2.5	7	.6	M6
8M16FBDK	8M16FBD/G5	8.4	16	2.5	9.5	.75	M8
10M20FBDK	10M20FBD/G5	10.4	20	3	11.5	.75	M10
12M24FBDK	12M24FBD/G5	12.5	24	3.5	14	1	M12
14M28FBDK	14M28FBD/G5	14.5	28	3.5	16	1	M14
16M30FBDK	16M30FBD/G5	16.5	30	4	18	1	M16
18M34FBDK	18M34FBD/G5	18.5	34	5	21	1.5	M18
20M37FBDK	20M37FBD/G5	20.5	37	5	23	1.5	M20
22M40FBDK	22M40FBD/G5	22.5	40	5	25	1.5	M22
24M44FBDK	24M44FBD/G5	24.5	44	5	27	1.5	M24
27M50FBDK	27M50FBD/G5	28	50	6	31	1.5	M27
30M56FBDK	30M56FBD/G5	31	56	6	34	1.5	M30
36M66FBDK	36M66FBD/G5	37	66	7	40	2	M36