



ISO 9001 Supplier

RoHS Compliant



### EN 512 | Plastic Control Levers

Technopolymer Plastic



**Body** Special glass-fiber reinforced technopolymer plastic, black glossy finish

**Hub** Steel, black oxide finish, molded in

**Arm** Chrome-plated, matte finish, with phenolic handpiece

**Diameter  $d_1$**  37 – 75 mm (1.46 – 2.95 inch)

**Diameter  $d_2$**  8 – 18 mm (.315 – .709 inch)

**Length  $l$**  81 – 170 mm (3.19 – 6.69 inch)

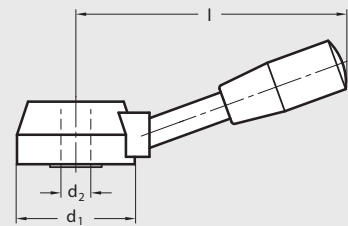

elesa®

Elesa Model LBR



ISO 9001 Supplier

RoHS Compliant



### GN 99.6 | Stainless Steel Clamp Nuts

Metric Size • With Tapped Through Holes



**Body** Stainless steel, matte shot blasted satin finish

**Length  $l_1$**  63 – 160 mm (2.48 – 6.30 inch)

**Diameter  $d_1$**  M8 – M20

**Shaft** Butt-welded to tapped hub

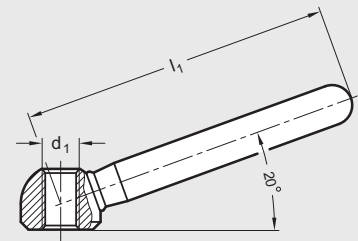

GANTER



ISO 9001 Supplier

RoHS Compliant



### GN 99.8 | Stainless Steel Double Arm Clamp Nuts

Metric Size • Stainless Steel



**Body** Stainless steel, matte shot blasted satin finish

**Length  $l$**  47.5 – 118 mm (1.87 – 4.65 inch)

**Diameter  $d_2$**  M8 – M20

**Clamp Arms** Butt-welded to tapped hub

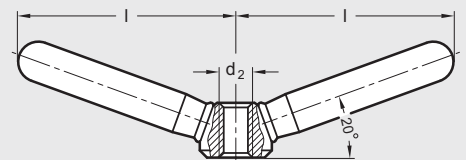

GANTER