

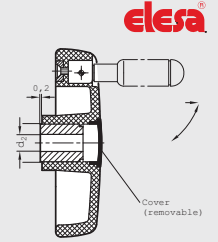

EN 621.3 | Ergostyle® Plastic Solid Handwheels

With Locking Retractable Handle • Inch and Metric Size

Body	Technopolymer plastic, black
Hub	Steel, black oxide finish
Retractable Handle	Black oxide steel mechanism and plastic revolving handle
Diameter d₁	4.92 – 6.93 inch (125 – 175 mm)
Diameter d₂	.375 – .500 inch or 12 – 16 mm

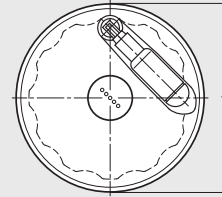

Elesa Model ESW + IR

ISO 9001 Supplier

Call for RoHS



EN 520.3 | Plastic Solid Disk Handwheels

With Locking Retractable Handle

Body	Duroplast (phenolic), black
Hub	Black oxide steel, blank, no pilot hole, molded in
Retractable Handle	Black oxide steel mechanism and plastic revolving handle
Diameter d₁	3.94 – 9.76 inch (100 – 250 mm)

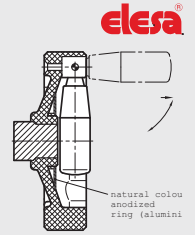
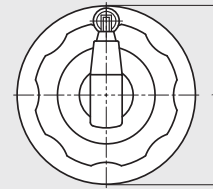

Elesa Model VDO.FP + IR

ISO 9001 Supplier

RoHS Compliant



EN 524 | Plastic Solid Disk Handwheels

With or without Revolving Handle • Inch Size

Body	Technopolymer plastic, black
Hub	Steel, black oxide finish
Revolving Handle	Plastic, zinc-plated steel spindle
Diameter d₁	3.93 – 7.87 inch (100 – 200 mm)
Diameter d₂	.375 – .625 inch

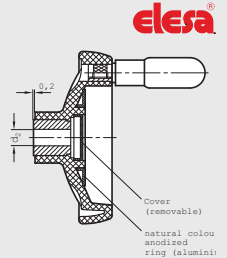
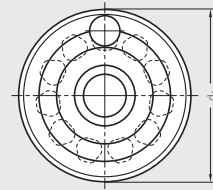

Elesa Model VDT, VDT+I

ISO 9001 Supplier

RoHS Compliant



EN 524.3 | Plastic Solid Disk Handwheels

With Locking Retractable • Inch Size

Body	Technopolymer plastic, black
Hub	Steel, black oxide finish
Retractable Handle	Plastic, zinc-plated steel spindle
Diameter d₁	3.93 – 7.87 inch (100 – 200 mm)
Diameter d₂	.375 – .625 inch

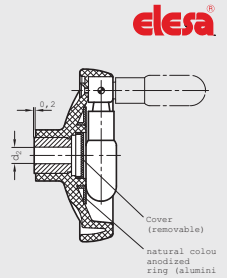
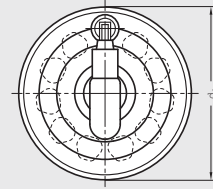

Elesa Model VDT+IR

ISO 9001 Supplier

RoHS Compliant