

GN 559 | Aluminum Cabinet / Door Handle

Metric Size • With Tapped Holes

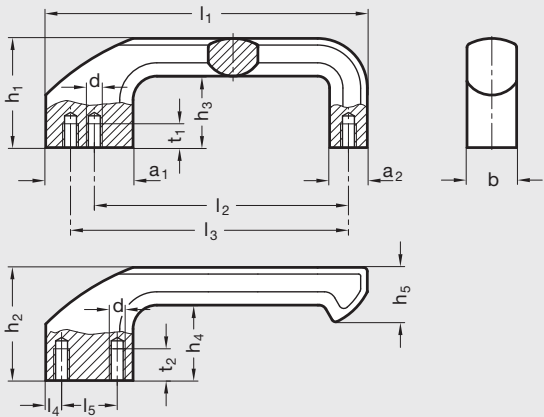

ISO 9001 Supplier RoHS Compliant

- Handle
- Cast aluminum
- Black powder coated pebble finish
- Tapped holes for mounting

GN 559 open-end or closed-end type handles are mainly used in applications requiring a sturdy and rugged grip.

A special characteristic of the GN 559 is the thumb rest pad on the front leg.

Because of the dual mounting holes, there is a choice of two center hole mountings on the closed-end handle.

Due to the dual mounting holes on the open-end handle, the handle is secured tightly into position after installation.

Various metric size fasteners and kit packaging available upon request.

Closed Series Table

Dimensions in: millimeters (inches)

Part Number Closed Series	l_1	d Tapped	l_2	l_3	a_1	a_2	b	h_1	h_3	t_1
25W162J20K/A	162 (6.38)	M8 x 1.25	128 (5.04)	140 (5.51)	38 (1.50)	19 (.75)	25 (.98)	55 (2.17)	36 (1.42)	12 (.47)

Open Series Table

Dimensions in: millimeters (inches)

Part Number Open Series	l_1	d Tapped	l_2	l_3	a_1	a_2	b	h_2	h_4	h_5	l_4	l_5	t_2
25W162J20K/B	162 (6.38)	M8 x 1.25	128 (5.04)	140 (5.51)	38 (1.50)	19 (.75)	25 (.98)	57 (2.24)	38 (1.50)	28 (1.10)	8 (.31)	22 (.87)	16 (.63)