



EN 500 | Adjustable Plastic Clamping Levers

Inch Size, Technopolymer • With Tapped Insert



Handle	Technopolymer
Insert	Black oxide steel
Length l_1	1.65 – 3.94 inch
Tapped d_1	10-24 – 5/8-11
Colors	Black, Orange, Gray

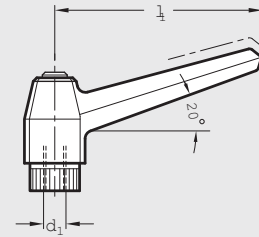

Elesa Model MR.

1

ISO 9001 Supplier

RoHS Compliant



EN 503.1 | Push Button Plastic Adjustable Levers

Inch And Metric Size, Stainless Steel • With Tapped Insert



Handle	Technopolymer
Insert	Stainless Steel
Length l_1	1.65 – 3.15 inch (42 – 80 mm)
Tapped d_1	1/4-20 – 5/16-18 (M 6 – M 10)
Button Colors	Black, Orange, Gray

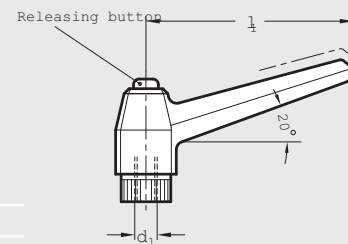

Elesa Model MRX.S

ISO 9001 Supplier

RoHS Compliant



EN 503.1 | Push Button Plastic Adjustable Levers

Inch and Metric Size, Stainless Steel • With Threaded Stud



Handle	Technopolymer
Stud	Stainless Steel
Length l_1	1.65 – 3.15 inch (42 – 80 mm)
Stud length l_2	.50 – 2.00 (16 – 30 mm)
Thread d_1	1/4-20 – 3/8-16 (M 6 – M 12)
Button Colors	Black, Orange, Gray

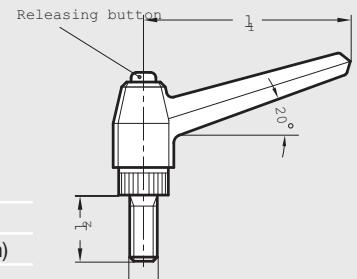

Elesa Model MRX.S-p

ISO 9001 Supplier

RoHS Compliant



GN 312 | Steel Safety Heavy Duty Adjustable Levers

Metric Size, Steel • Tapped Type



Handle	Carbon steel, black oxide finish
Ball knob	Black phenolic, DIN 319
Length l	2.76 – 4.88 inch (70 – 124 mm)
Tapped d_2	M 6 – M 16

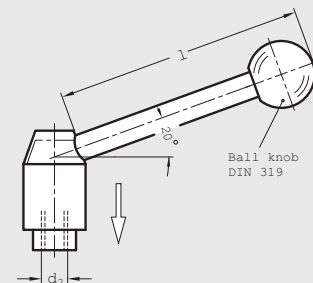

ISO 9001 Supplier

RoHS Compliant