



ISO 9001 Supplier

RoHS Compliant



EN 590 | Fluted Grip Knobs

Inch and Metric Size • With Blind Tapped or Tapped Through Insert

Knob Body	Technopolymer plastic
Insert	Brass, molded-in
Diameter d_1	.63 – 1.26 inch (16 – 32 mm)
Thread d_3	8-32 – 5/16-18 or M4 – M10

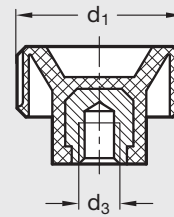

elesa®

Elesa Model BT, BT.FP



ISO 9001 Supplier

RoHS Compliant



EN 591 | Fluted Grip Knobs

Inch and Metric Size • With Threaded Stud

Knob Body	Technopolymer plastic
Insert	Steel, zinc-plated
Diameter d_1	.63 – 1.26 inch (16 – 32 mm)
Thread d_2	8-32 – 5/16-18 or M4 – M10
Length l	.38 – 1.00 inch or 10 – 20 mm

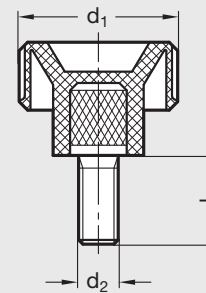

elesa®

Elesa Model BT.p



NEW

ISO 9001 Supplier

RoHS Compliant



EN 591-NI | Fluted Grip Knobs

Metric Size • With Stainless Steel Tapped Insert



Knob Body	Technopolymer plastic
Insert	Stainless steel
Diameter D	.79 – 1.26 inch (20 – 32 mm)
Thread d	M5 – M8

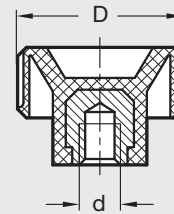

elesa®

Elesa Model BT.S-INOX



NEW

ISO 9001 Supplier

RoHS Compliant



EN 591-NI | Fluted Grip Knobs

Metric Size • With Stainless Steel Threaded Stud



Knob Body	Technopolymer plastic
Insert	Stainless steel
Diameter D	.79 – 1.26 inch (20 – 32 mm)
Thread d	M5 – M8
Length l	10 – 30 mm

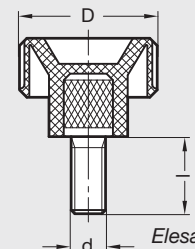

elesa®

Elesa Model BT.S-p-INOX