

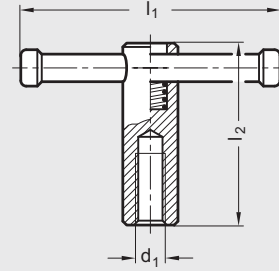

DIN 6307 | Steel Tommy Nuts

Metric Size • Tapped Type with Movable Bar

Body	Steel, black oxide finish
Bar end caps	Pressed onto the bar, gray plastic
Length l_2	60 – 95 mm (2.36 – 3.74 inch)
Length l_1	80 – 140 mm (3.15 – 5.51 inch)
Diameter d_1	M10 – M20



ISO 9001 Supplier

RoHS Compliant



GN 6306 | Steel Tommy Screws

Metric Size • Stud Type with Movable Bar

Body	Sandblasted Steel, black oxide finish
Bar end caps	Pressed onto the bar, gray plastic
Length l_1	40 – 90 mm
Length l_3	80 – 140 mm (3.15 – 5.51 inch)
Diameter d_1	M10 – M20

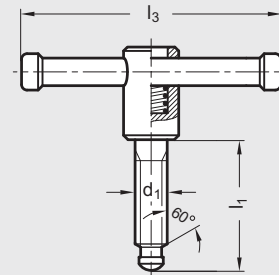

ISO 9001 Supplier

RoHS Compliant

Thrust pad, see DIN 6311, page 637



GN 310-NI | Stainless Steel Gear Lever Handles

Metric Size



Shaft	Stainless steel
Knobs	Black phenolic plastic
Length l_1	63 – 200 mm (2.48 – 7.87 inch)
Diameter d_2	M6 – M12

Available with ball knob DIN 319 or cylindrical handle GN 519

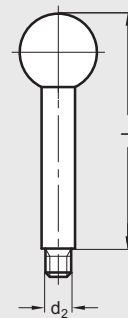

ISO 9001 Supplier

RoHS Compliant