

**GN 183 | C-Washers**

Metric Size

<b>Body</b>	Steel, case hardened
<b>Diameter <math>d_1</math></b>	.87 – 2.20 inch (22 – 56 mm)
<b>Diameter <math>b</math></b>	.24 – .65 inch (6.2 – 16.5 mm)

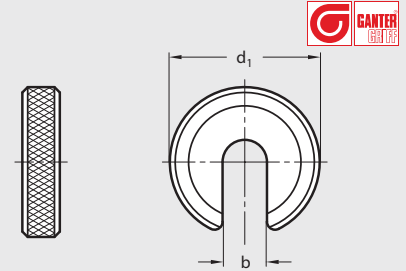

ISO 9001 Supplier

RoHS Compliant



**DIN 6371 | Captive C-Washers**

Metric Size

<b>Body</b>	Steel, tempered
<b>Diameter <math>d_1</math></b>	1.50 – 3.82 inch (38 – 97 mm)
<b>Diameter <math>b</math></b>	.30 – 1.26 inch (7.5 – 32 mm)
<b>Screw</b>	M6 – M8

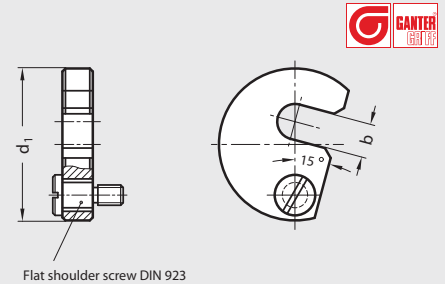

Flat shoulder screw DIN 923

ISO 9001 Supplier

RoHS Compliant



**HDCW | Heavy Duty C-Washers**

Inch Size

<b>Body</b>	Steel, case hardened
<b>Diameter <math>A</math></b>	.28 – 1.03 inch (7.1 – 26.2 mm)
<b>Diameter <math>C</math></b>	1.25 – 3.00 inch (31.8 – 76.2 mm)

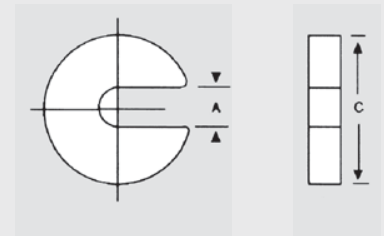

RoHS Compliant



**SCW | Swing C-Washers**

Inch Size

<b>Body</b>	Steel, hardened
<b>A</b>	1 – 1.75 inch (25.4 – 44.5 mm)
<b>Diameter <math>C</math></b>	.41 – .78 inch (10.4 – 19.8 mm)

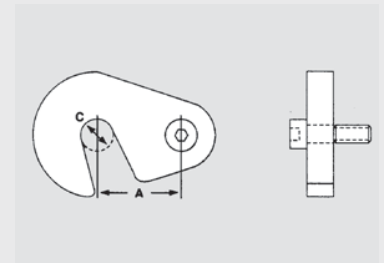

RoHS Compliant