

GN 728 | Aluminum Cabinet “U” Handles

Economical • Tapped or Through Hole

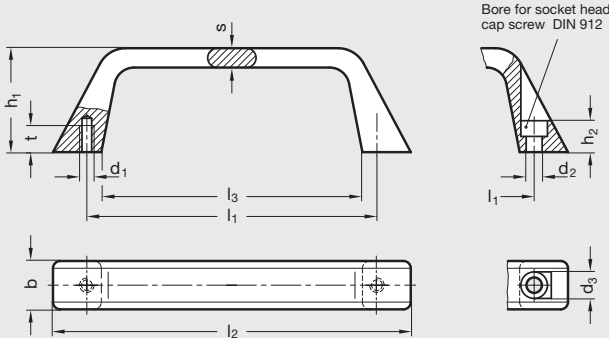

ISO 9001 Supplier RoHS Compliant

Handle
Pressure die-cast aluminum

Black powder-coated finish (K) is standard; for tumbled finish substitute “T” for “K” in part number

Type A
Bottom mount (blind tapped hole)

Type B
Top mount for socket head cap screws (d2: Fits metric M6 or M8 and 1/4" or 5/16" respectively)

Low cost alternative in metal.
Hole center dimension is identical in both versions, so they can be mounted in pairs opposite each other.

Metric Table

Dimensions in: millimeters (inches)

Part Number		b	l ₁	d ₁ Tapped	d ₂ Through Hole	d ₃	h ₁	h ₂	l ₂	l ₃	s	t min.
Type A	Type B											
225W120D97K/A	225W120D97K/B	22.5 (.89)	120 (4.72)	M6 x 1.0	6.4 (.252)	11 (.43)	42.5 (1.67)	13 (.51)	147 (5.79)	108 (4.25)	8 (.31)	10 (.39)
27W180D97K/A	27W180D97K/B	27 (1.06)	180 (7.09)	M8 x 1.25	8.4 (.331)	13.5 (.53)	47.5 (1.87)	16 (.63)	214 (8.43)	165 (6.5)	10 (.39)	12 (.47)