

GN 798 | Plastic or Aluminum Stepped Revolving Handles

Metric Size • With Steel Spindle

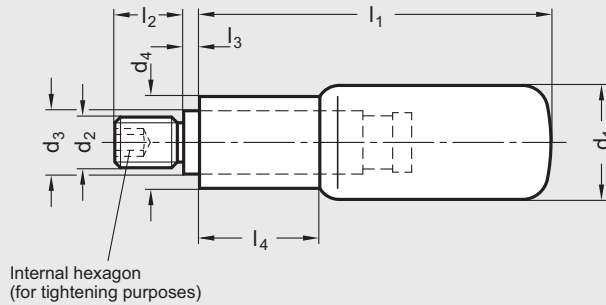

4

Revolving and Operating Handles

ISO 9001 Supplier

Hand piece, plastic version

Black nylon plastic, matte finish

Hand piece, aluminum version

Aluminum, turned and polished

Threaded spindle

Steel, zinc plated with internal hexagon

Stepped cylindrical revolving handles are noted for their modern design, and the stepped shape provides the operator with a better grip.

Maximum heat resistance of nylon plastic hand piece: 90°C (194°F).

DIN 911 hex keys used for mounting these handles, are available upon request.

Metric Table

Dimensions in: millimeters (*inches*)

Part Number		d ₁	d ₂ Thread	d ₃	d ₄	l ₁	l ₂	l ₃	l ₄	Int. Hex A/F
Nylon Plastic	Aluminum									
6NJ50	6NJ56	16 (.63)	M6 x 1.0	10 (.39)	13 (.51)	41.5 (1.63)	12 (.47)	2.5 (.10)	15 (.59)	3 (.12)
6NJ51	6NJ57	18 (.71)	M6 x 1.0	10 (.39)	14.5 (.57)	56 (2.20)	13 (.51)	2.5 (.10)	19 (.75)	3 (.12)
8NJ51	8NJ57	18 (.71)	M8 x 1.25	10 (.39)	14.5 (.57)	56 (2.20)	13 (.51)	2.5 (.10)	19 (.75)	4 (.16)
8NJ52	8NJ58	22 (.87)	M8 x 1.25	14 (.55)	18.5 (.73)	59 (2.32)	14 (.55)	2.5 (.10)	21 (.83)	4 (.16)
10NJ52	10NJ58	22 (.87)	M10 x 1.5	14 (.55)	18.5 (.73)	59 (2.32)	14 (.55)	2.5 (.10)	21 (.83)	5 (.20)
8NJ53	8NJ59	24 (.94)	M8 x 1.25	14 (.55)	18.5 (.73)	74 (2.91)	16 (.63)	2.5 (.10)	27 (1.06)	4 (.16)
10NJ53	10NJ59	24 (.94)	M10 x 1.5	14 (.55)	18.5 (.73)	74 (2.91)	16 (.63)	2.5 (.10)	27 (1.06)	5 (.20)
10NJ54	10NJ60	25 (.98)	M10 x 1.5	16 (.63)	20 (.79)	84 (3.31)	16 (.63)	2.5 (.10)	30 (1.18)	5 (.20)