



NEW



**GN 709.2 | Clamping Pads**

Metric Size • With Tapped Body

<b>Body</b>	Steel, hardened
<b>Diameter <math>d_1</math></b>	.47 – 1.10 inch (12 – 28 mm)
<b>Thread <math>d_2</math></b>	M3 – M5
<b>Max. Load</b>	10 – 90 KN

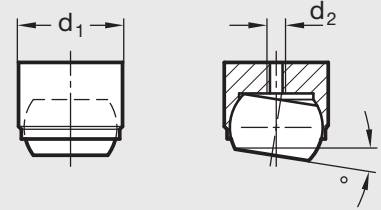

ISO 9001 Supplier

RoHS Compliant



NEW



**GN 709.3 | Clamping Pads**

Metric Size • With Height Adjustment

<b>Body</b>	Steel, hardened
<b>A/F1/2</b>	.51 – 1.18 inch (13 – 30 mm)
<b>Thread <math>d_1</math></b>	M8 – M20
<b>Max. Load</b>	8 – 90 KN

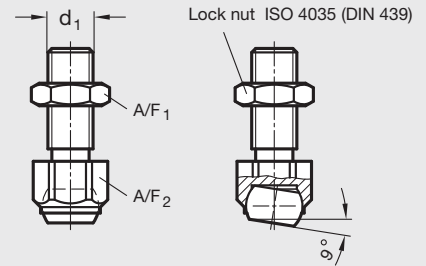

ISO 9001 Supplier

RoHS Compliant

11

Jig, Fixture and Fastening Components



**GN 732 | Cylinder Head Shoulder Bolts**

Metric Size

<b>Body</b>	Steel, black oxide finish
<b>Thread <math>d_1</math></b>	M6 – M10
<b>Length <math>l_1</math></b>	5 – 16 mm
<b>Diameter <math>d_3</math></b>	.55 – .75 inch (14 – 19 mm)

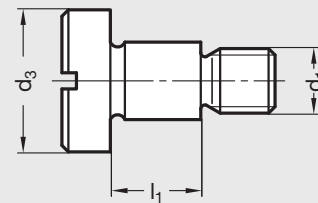

ISO 9001 Supplier

RoHS Compliant



**DIN 6379 | Double Ended Threaded Studs**

Metric Size

<b>Stud</b>	Steel, rolled thread
<b>Thread <math>d</math></b>	M6 – M42
<b>Length <math>L</math></b>	32 – 500 mm

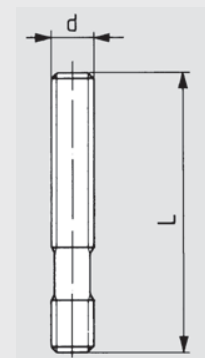

ISO 9001 Supplier

RoHS Compliant