

EN 5337.4 | Technopolymer Plastic Solid Five Lobed Knobs

Metric Size • With Stainless Steel Tapped Insert

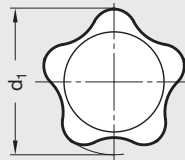
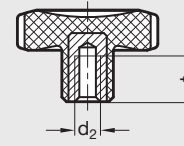
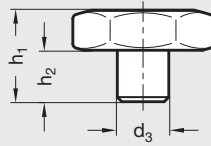

elesa®

ISO 9001 Supplier

RoHS Compliant

Hand knob

Special glass-fiber reinforced technopolymer plastic, black matte finish

Tapped insert

AISI 303 stainless steel, molded in

Elesa® original design technopolymer plastic solid five lobed knobs.

This technopolymer knob has been designed for applications on machines and equipment whose parts, for health reasons, must be frequently cleaned, using water jets or steam.

The five-lobed shape, which offers the fingers a secure grip, is solid, so that there are no cavities where unhealthy residues may be deposited.

Resistant to solvents, oils, grease and other chemical agents.

Elesa Model VC.692S-INOX

Metric Table

Dimensions in: millimeters (inches)

Part Number	d ₁	d ₂ Tapped	d ₃	h ₁	h ₂	t min.
6NBR3	32 (1.26)	M6 x 1.0	14 (.55)	22.5 (.89)	12.5 (.49)	10 (.39)
8NBR4	40 (1.57)	M8 x 1.25	15 (.59)	26 (1.02)	14 (.55)	12 (.47)
10NBR5	50 (1.97)	M10 x 1.5	18 (.71)	31 (1.22)	17 (.67)	16 (.63)
12NBR6	60 (2.36)	M12 x 1.75	21 (.83)	37 (1.46)	21 (.83)	20 (.79)

8

Clamping Knobs