

## Destaloradora de ruedas SERIE BB

### 10 toneladas Hidráulica

Destalora las llantas hidráulica-  
mente entre 25" y 49"

#### DESTALORADORA DE RUEDAS

- Diseñada para encargarla en el alojamiento para la palanca.
- La presión hidráulica realiza todo el destaloramiento.
- Ligera y portátil.
- Se recomienda utilizarla con la bomba P55 y la manguera 9764 E.

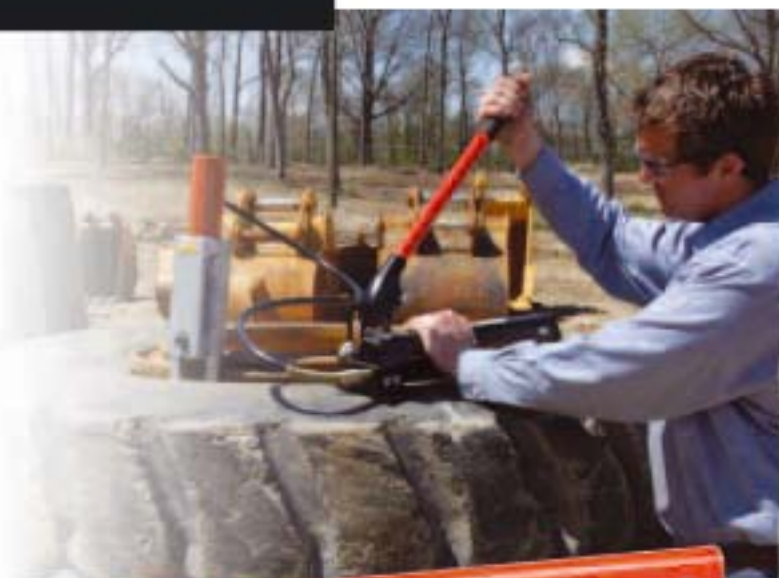

HERRAMIENTAS HIDRÁULICAS

Modelo herramienta	Peso herramienta kg.	Tamaño llanta	Capacidad cilindro	carrera (mm)
BB-1600	10,25	25"-49"	10	101,6
BB1601	10,9	25"-49" Simple, dos, tres piezas de llanta	10	101,6
Consultar en fabrica	13,65	25"-51"	12,3	107,9



# 10 ton hydraulic Tire Removing Set

E Unscat tire beads hydraulically on 25"- 49" diameter earth mover rims with pry bar pockets in the bead seat band and rim back section.

The No. BB-1 600 makes a tiring chore simple. Hydraulics make tire removal quick and easy without damaging the wheel or any component parts. At only 22112 pounds, it's complete portable, so it can be used with tires on or off the vehicle.

*see reverse side  
for more information*



# Demount tires on the vehicle

Using the BS-1 600 is easy. It's made to fit into a pry bar pocket to depress the flange about 3/4". Then it's placed under the lip of the bead seat band at points around the rim. Hydraulic pressure does all the unseating, quickly and easily. The entire BB-1 600 is light-weight (only 22112 lbs.) and portable, making it ideal for use in the shop or outside. It does not include the hydraulic pump, hose or hose half coupler (see below).

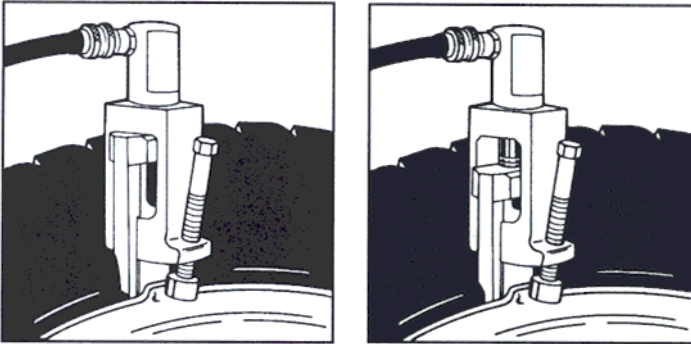

BB-1600 hook in one of the pry bar pockets. BB-1 600 depressing flange for tire removal.

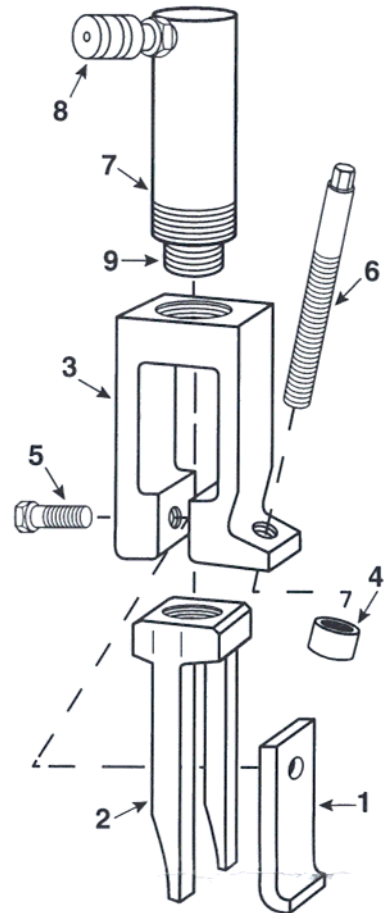

## WARNING

This bulletin is not intended for use as an instruction manual. To help prevent personal injury, ALWAYS CAREFULLY READ AND FOLLOW ALL INSTRUCTIONS. Complete instructions are included with every BB-1600.

Do not use any hydraulic pump which is capable of producing more than 10,000 p.s.i. hydraulic pressure. Components of the BB-1 600 or the wheel may be damaged.

## How to order:

**No. BB-1 600** - Hydraulic tire removing equipment. Includes parts shown at right. Wt., 22112 lbs.

*It is recommended you use the BB-1600 with the POWER TEAM No. P55 hydraulic hand pump and the POWER TEAM No. 9764 6-ft. hose with hose half coupler.*



## Contents of set No. BB-1600

POWER TEAM		
Item No.	Part No.	Description
1	36958	Hook
2	41086	Clevis
3	41084	Frame
4	202821	Pressure Nut
5	22469	Shoulder Screw
6	38809	Set Screw
7	C102C	Ram
8	9796	Ram Coupler
9	202179	Threaded Adapter



SPXFluidPower  
5885 Jth ST  
Rockford, IL 61109-3699 USA  
Telephone: 1-815-874-5559 Fax: 1-815-874-7853 Customer  
Service: 1-800-541-1418 Fax 1-800-288-7031  
TechnicalServices: 1-800-477-8326 Fax.- 1-800-765-8326

DISTRIBUTED BY: